

# JONIX minimize

USE AND MAINTENANCE MANUAL

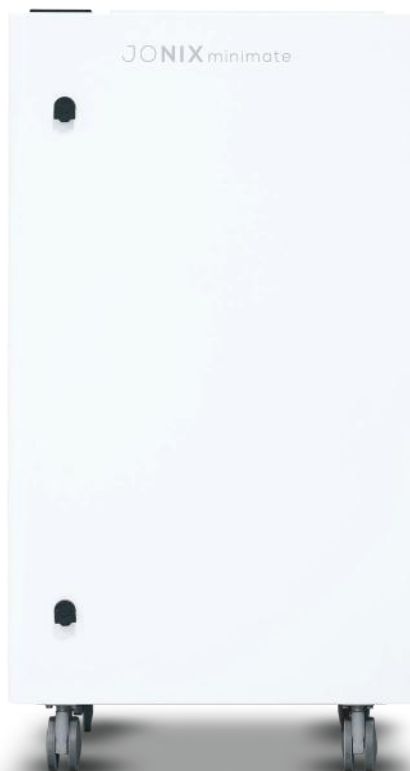

**AIR PURIFICATION DEVICE  
WITH ADVANCED COLD PLASMA TECHNOLOGY**

These instructions are translated from Italian (the original language).

JONIX srl reserves every right concerning this manual, including the right to make any necessary change or improvement to its products and to the manual at any time and without notice. It is forbidden to reproduce in full or in part this manual without JONIX srl's consent.

## TABLE OF CONTENTS

<b>1 - GENERAL INFORMATION</b>	<b>5</b>
1.1 - SERIAL NUMBER PLATE	5
1.2 - LIABILITY	5
1.3 - SYMBOLS	6
<b>2 - WARNINGS AND GENERAL PROHIBITIONS</b>	<b>6</b>
<b>3 - THE OPERATING SYSTEM</b>	<b>8</b>
<b>4 - TECHNICAL DATA</b>	<b>9</b>
4.1 - COMPONENT DESCRIPTION JONIX <sub>minimate</sub> (WHEELED VERSION)	9
4.1.1 - Technical features JONIX <sub>minimate</sub> (WHEELED VERSION)	9
4.2 - COMPONENT DESCRIPTION JONIX <sub>minimate</sub> (WALL MOUNTED VERSION)	10
4.2.1 - Technical features JONIX <sub>minimate</sub> (WALL MOUNTED VERSION)	10
<b>5 - RECEPTION, TRANSPORT AND STORAGE</b>	<b>11</b>
5.1 - PACKAGING	11
5.2 - HANDLING AND TRANSPORT	11
5.3 - INSPECTION UPON RECEPTION	11
5.4 - STORAGE	11
5.5 - HANDLING DEVICE IN OPERATING CONDITIONS	11
<b>6 - INSTALLATION AND COMMISSIONING</b>	<b>12</b>
6.1 - SAFETY STANDARDS	12
6.2 - GETTING STARTED	13
6.3 - CHOOSING THE INSTALLATION SITE	14
6.3.1 - Guidelines for wall mounting	14
6.3.2 - Guidelines for floor-mounting	16
6.4 - ELECTRICAL CONNECTIONS	16
6.5 - ELECTRIC POWER SUPPLY	16
6.6 - USING THE DEVICE	17
6.7 - DEFAULT SETTINGS	17
6.8 - USER INTERFACE AND MENU NAVIGATION	18
6.8.1 - Main screen	18
6.8.2 - Ionisers screen	20
6.8.3 - Fan screen	20
6.8.4 - Filters screen	20
6.8.5 - Settings screen	21
6.8.5.1 - Date and time	21
6.8.5.2 - Language	21
6.8.5.3 - Display	21
6.8.5.4 - Protection	22
6.8.5.5 - Time slots	22
6.8.5.6 - Maintenance	24
6.8.5.7 - Alarms history	25
6.8.5.8 - Configuration	25
6.8.5.9 - Multimedia screen	25

<b>7 - MAINTENANCE</b>	<b>26</b>
7.1 - WARNINGS	26
7.2 - ROUTINE MAINTENANCE	26
7.2.1 - Cleaning the Ionising Tubes	27
7.2.2 - External cleaning of the equipment	30
7.3 - SPECIAL MAINTENANCE	31
7.3.1 - Replacing the Ionising Tubes	31
7.3.2 - Replacing filters	34
<b>8 - OPERATIONAL CHECK AND TROUBLESHOOTING</b>	<b>36</b>
<b>9 - DISPOSAL</b>	<b>37</b>
<b>WARRANTY CONDITIONS</b>	<b>38</b>
<b>EC DECLARATION OF CONFORMITY</b>	<b>39</b>
<b>ATTACHMENTS</b>	<b>40</b>
EXPLODED JONIX <sup>minimate</sup> (WHEELED VERSION)	40
EXPLODED JONIX <sup>minimate</sup> (WALL MOUNTED VERSION)	41
OVERALL DIMENSIONS JONIX <sup>minimate</sup> (WHEELED VERSION)	42
OVERALL DIMENSIONS JONIX <sup>minimate</sup> (WALL MOUNTED VERSION)	43
ELECTRICAL DIAGRAMS JONIX <sup>minimate</sup>	44

Thank you purchasing the JONIX<sup>minimate</sup> device.

This manual contains the information and all that is required for the transportation, installation, use and maintenance of the JONIX<sup>minimate</sup> sanitation and filtering module.

Improper installation of the device and/or failure to comply with the instructions in this manual, may invalidate the warranty that the Manufacturer issues for its products.

The Manufacturer is not liable for any direct and/or indirect damage caused by incorrect installation or damage caused by the units installed by inexperienced and/or unauthorised staff. At the time of purchase, check that the device is intact and complete.

The Manufacturer declines any liability in case of personal injury or property damage resulting from any improper use of the device or from the failure to observe the use and safety instructions specified in this manual. In any such case, any warranty claim will be void.





Any complaints must be submitted in writing within **8 days** of receiving the goods.

For more information, download of the manual or video tutorial, we invite you to visit [www.jonixair.com](http://www.jonixair.com).

## 1 - GENERAL INFORMATION

### 1.1 SERIAL NUMBER PLATE

The equipment described in this manual is provided with a plate (applied inside the panelling that closes access to the filters and to the ionising modules) containing the equipment and Manufacturer data:

Fabbricante / Manufacturer 	<b>JONIX S.R.L.</b> Viale Spagna, 31/33 35020 Tribano (PD)
Nome del prodotto / Product name	<b>JONIX</b> minimize
Descrizione del prodotto / Product description	Dispositivo per la sanificazione attiva e purificazione dell'aria
Codice prodotto / Model	<b>REF</b> 70WHMINIMATE4
Numero di serie / Serial number	<b>SN</b> xxxxxxxxxxx
Caratteristiche elettriche Alimentazione / Power Supply	230V / ~1 / 50Hz
Potenza nominale Assorbita / Power Consumption (W)	560
Corrente massima / Full load amperes (A)	2,4
    	

The sanitation and filtering module **JONIX** minimize is in compliance with Directives 2006/42/CE, 2011/65/UE, 2014/30/UE, 2014/35/UE and subsequent amendments.

### IMPORTANT WARNING

**The **JONIX** minimize device is designed and made to sanitise the air in residential environments that are incompatible with toxic and flammable gases. It is therefore strictly forbidden to use the device in environments where the air is mixed with and/or altered by other gaseous compounds and/or solid particles. Using the device for purposes other than those intended and that do not comply with those described in this manual, will immediately relieve the manufacturer and its distributors from any direct and/or indirect liability.**

### 1.2 LIABILITY

Failure to comply with the instructions contained in this Use and maintenance manual relieves the Manufacturer from any liability. For any information not included or that cannot be deduced from the Manual, consult the Manufacturer directly.

JONIX srl  
Viale Spagna 31/33  
35020 Tribano - PD - Italy  
<http://www.jonixair.com>

In particular, if equipment maintenance is carried out in a way that is not in compliance with the instructions supplied, or in a way to jeopardise integrity or modify features, **JONIX** srl is relieved from any liability inherent to safety of persons and faulty operation of the equipments.

## 1.3 SYMBOLS

Please pay utmost attention to the following symbols and their meaning. They emphasise specific information, such as:



**WARNING:** It refers to integrations or suggestions concerning the proper use of the device.



**HAZARD:** It refers to dangerous situations that may result from the use of the device, in order to ensure personal safety.



**FORBIDDEN:** This symbol refers to operations that must be avoided under any circumstances, and hence forbidden.



**HIGH VOLTAGE HAZARD!**

Do not open or remove any doors or protections before disconnecting the voltage supply.



**WARNING!**

It is mandatory to use protective gloves.



**WASTE FROM ELECTRICAL AND ELECTRONIC EQUIPMENT.**

The crossed-out wheelie bin symbol on the equipment label indicates that the equipment is compliant with the Waste Electrical and Electronic Equipment (WEEE) Directive. Disposing of the equipment freely in the environment or illegally disposing of the equipment are punishable by law.

## 2 - WARNINGS AND GENERAL PROHIBITIONS



This instruction manual is an integral part of the device and therefore must be kept carefully and must ALWAYS accompany the device, even in the event that it is sold to another owner or user or transferred to another facility. In the event that it is damaged or lost contact JONIX srl for another copy or download the document from [www.jonixair.com](http://www.jonixair.com).



Repairs and maintenance work must be carried out by JONIX srl authorised staff or by qualified staff according to the provisions set out by this manual. Do not alter or tamper with the device as it can lead to hazards and the manufacturer of the device shall not be liable for any damage caused.



After removing the packaging check that the contents are intact and complete. In the event of a noncompliance please contact the Company that sold you the device.



**When installing, commissioning and operating this product, it is mandatory to observe the requirements and instructions specified in this manual.**



**JONIX srl disclaims any liability for damage caused to people, animals or property due to installation, adjustment and maintenance errors or by improper use.**

Please note that the use of products that require electricity, involves the observance of some crucial safety rules such as:



**This device is not intended for use by people (including children) with reduced physical, mental or sensory capabilities or without experience and knowledge, unless they are supervised or are given instructions to use the appliance by a person responsible for their safety. Take suitable precautions to prevent children from playing with the device.**



**Do not touch the device if you are barefoot and with parts of the body that are wet or damp.**



**Do not carry out any maintenance or cleaning operations without having first disconnected the device from the mains, by turning the main system switch to “OFF”.**



**Do not alter the safety or adjustment devices without prior authorisation and instructions from the manufacturer of the device.**



**Do not pull, detach or twist the electrical wires coming out of the device, even when it is disconnected from the mains.**



**Do not stand, sit and/or rest any type of object on the device.**



**Do not spray or throw water or other liquids directly onto the device.**



**Do not open the panels for accessing the internal parts of the device without having first turned the system switch to “OFF”.**



**Not dispose of or leave the packaging materials within reach of children because it can be potentially dangerous.**

### 3 - THE OPERATING SYSTEM

This sanitization device, by exploiting the physical process of ionisation, promotes the controlled formation of particular ionic species (electrically charged species) in the air, through an electrostatic field that simulates the natural process that normally occurs through solar radiation, mechanically or by means of other physical phenomena.

The particular ionic species produced have proved to be particularly effective as sanitizing agents in the air and on surfaces, moreover are historically and scientifically proven to be beneficial in people, especially those with a negative electrical charge (arising from individual or small groups of molecules that receive an electron).

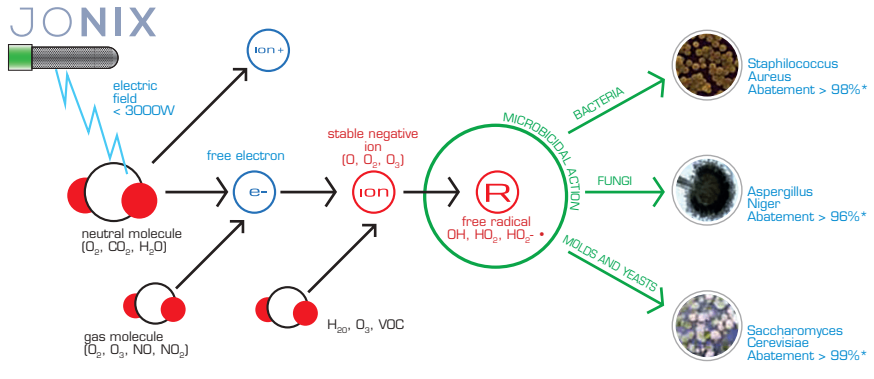

The JONIX minimate mobile filtering and sanitation module, is the ideal solution for purifying and decontaminating air in environments at risk such as hospitals, clean rooms, food processing and packaging rooms and clinics.

It is immediately operational after installation, requiring no further operations.

The device combines 3 progressive filtration stages to active air sanitization before it is reintroduced into the environment.

The advanced control system adjusts ventilation and the ionising load necessary to sanitise and purify air.

It is designed for quick and convenient maintenance as all its components can be accessed from the front.

Compact, portable and quiet, the JONIX minimate module quickly and effectively meets the requirements of reducing bacterial and particulate load.

The device has a safety switch, positioned in such a way that when the protection cover (also accidental) is opened, the power supply to the ionizing units and the fan is removed.

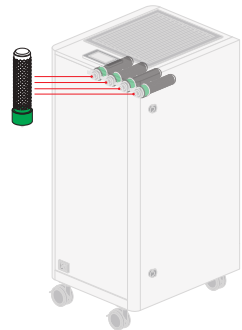



## 4 - TECHNICAL DATA

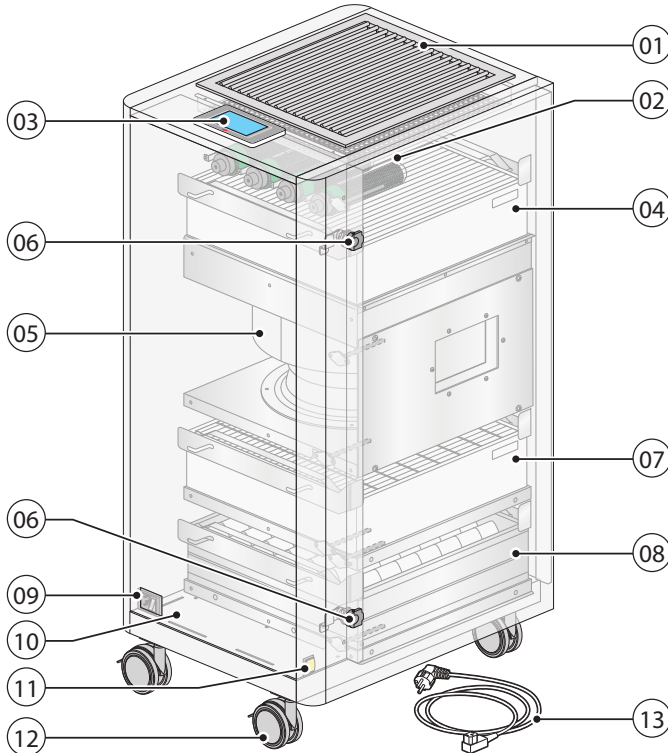

### 4.1 COMPONENT DESCRIPTION JONIX minimate (WHEELED VERSION)

01 Adjustable 2 way air outlet register	08 Prefilter particulate coarse G4
02 Ionising modules JONIX	09 Flat Plug Power Socket Inlets with On/Off Rocker Switch
03 Display Touch screen	10 Moveable aspiration mesh
04 Thin particulate filter F9 (or H13)	11 Switch button
05 Centrifugal fan	12 Swivel casters with brake
06 Anterior panel handle to access filters	13 Power cable
07 Thin particulate filter F7	

### 4.1.1 Technical features JONIX minimate (WHEELED VERSION)

Model	Dimensions (WxDxH) [mm]	Power Supply	Max power absorption [W]	Air flow rate [m³/h]	Weight [Kg]
JONIX minimate	560 x 460 x 1060	230 V / ~1 / 50Hz	560	from 400 to 2000	65

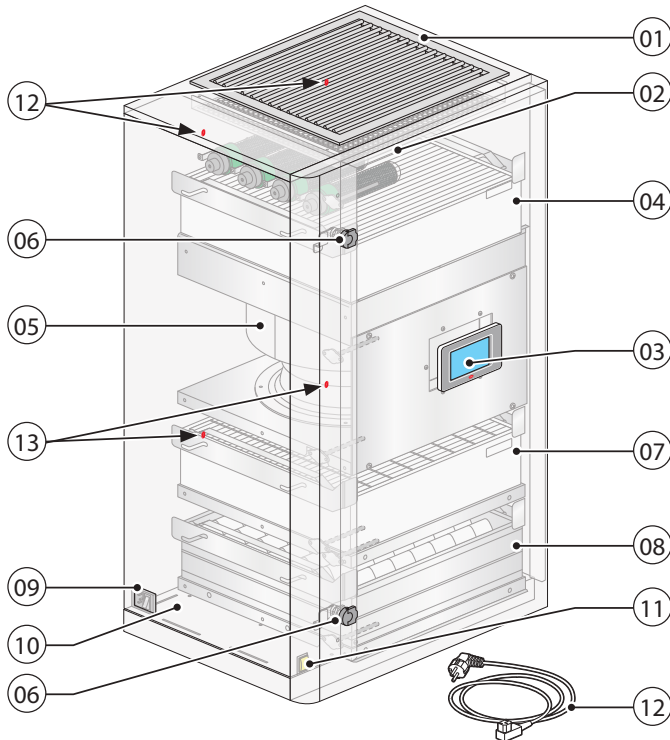

## 4.2 COMPONENT DESCRIPTION JONIX<sub>minimate</sub> (WHEELED VERSION)

01 Adjustable 2 way air outlet register	08 Prefilter particulate coarse G4
02 Ionising modules JONIX	09 Flat Plug Power Socket Inlets with On/Off Rocker Switch
03 Display Touch screen	10 Moveable aspiration mesh
04 Thin particulate filter F9 (or H13)	11 Switch button
05 Centrifugal fan	12 Power cable
06 Anterior panel closure to access filters	13 Posterior holes for wall attachment
07 Thin particulate filter F7	

### 4.2.1 Technical features JONIX<sub>minimate</sub> (WHEELED VERSION)

Model	Dimensions (WxDxH) [mm]	Power Supply	Max power absorption [W]	Air flow rate [m <sup>3</sup> /h]	Weight [Kg]
JONIX <sub>minimate</sub>	560 x 425 x 950	230 V / ~1 / 50Hz	560	from 400 to 2000	55



For the code of replacement components, refer to the "ATTACHMENTS" section.

## 5 - TRANSPORTATION AND HANDLING

### 5.1 PACKAGING

JONIX<sup>minimate</sup> and its accessories are delivered in specific protective packaging and must remain intact until they are assembled. The materials that were not installed for technical requirements are supplied with suitable enclosure secured to the inside or outside of the device itself. The package includes:

- JONIX<sup>minimate</sup> sanitation and filtering module.
- Operating and maintenance manual (with dimensional diagrams, wiring diagrams, Declaration of Conformity).

### 5.2 HANDLING AND TRANSPORT



To handle the device use appropriate means, depending on the weight, as required by Directive 89/391/EEC and subsequent amendments.



Please take great care while unloading and positioning the devices, to prevent damaging the casing or components. Avoid uncontrolled rotations.

The weight of every single device is given in this manual.

### 5.3 INSPECTION UPON RECEPTION

When you receive the device please check all its parts, in order to make sure that it has not been damaged during transport.

Any damage must be reported to the carrier, by filling in the relevant section on the delivery note and specifying the type of damage.



Any type of complaint must be sent in writing within eight days from receiving the goods.

### 5.4 STORAGE

In the event of extended storage keep the devices away from dust and sources of vibration and heat.



The Manufacturer disclaims any liability for damage due to incorrect unloading failure to protect the device from the elements.

### 5.5 HANDLING DEVICE IN OPERATING CONDITIONS

The JONIX<sup>minimate</sup> device can easily be moved in various types of environments, as it has 4 360° rotating wheels. It can be blocked and secured in its operating position by the brakes on the wheels (see Chap. "Technical Data"). Also a version of the device to be wall mounted is available (see Chap. "Technical Data" and "Instructions for wall fixing").

**6 - INSTALLATION AND COMMISSIONING**



**ATTENTION!** Before carrying out any operation on the devices read **ALL** the instructions in this manual carefully.

Definitions:		
<p><b>USER:</b> Person, organisation or company who or which has purchased or rented the device and is going to use it for the intended purposes.</p>	<p><b>USER/OPERATOR:</b> Individual who has been authorised by the user to operate the device.</p>	<p><b>QUALIFIED STAFF:</b> Individuals who have completed a specific course and are therefore able to recognise the hazards arising from the use of this device and are able to prevent them.</p>

**6.1 SAFETY STANDARDS**



**The Manufacturer disclaims any liability for failure to comply with the safety and prevention standards as described below.**

**The Manufacturer also disclaims any liability for damage caused by improper use of sanitisers and/or alterations carried out without prior authorisation.**

- The device must be installed in strict accordance with the instructions contained in this manual.
- Wear suitable accident prevention clothing when installing the device, such as: goggles, gloves, etc. as instructed in standard 686/89/EEC and subsequent amendments.
- While performing installation, operate in full safety, in a clean environment clear of obstructions.
- Comply with the laws in force in the country in which the device is installed, regarding the use and disposal of the packaging and products used for cleaning and servicing the device; you should also observe the recommendations given by the manufacturer of such products.
- **Before switching the device on check the integrity of the various components and of the electrical mains to which it is connected, making sure that it is fitted with a circuit breaker upstream of the power line as shown in this manual.**
- Never insert objects of any kind into the device, as coming into contact with live parts or electrical terminals may cause fires or electric shocks.



**WARNING!**

**Mechanical machinery in motion and dangerous points of voltage inside the device. Risk of dragging and entrapment or electric shock.**

- Do not service or clean the device without first unplugging it from the mains.

- Worn or damaged parts must only be repaired or replaced by qualified staff and by following the instructions given in this manual.
- The spare parts must be approved by the Manufacturer.
- In the event of decommissioning or disposing of the device, follow the anti-pollution regulations set out by the country in which the device is installed.
- When drilling holes in walls, make sure not to interfere with wires, piping or anything else which could be damaged.
- Do not pour water or any kind of liquids on the device.
- Place the device so that the power cable cannot be stepped on.
- Do not connect the device to power lines connected to any other electric utilities or devices.
- **Use the type of power supply shown on the label. If you are not sure about the type of power supply available, ask your local retailer or electricity provider for assistance.**
- Do not touch the inside of the device, unless specified otherwise in the instructions contained in this manual.
- Never force the components when assembling: although it is made with high strength materials, the parts of the device can be damaged if handled incorrectly.
- Do not try to perform maintenance work on the device, except where specified in this manual. Opening or removing the outer casing may expose you to dangerous live parts or may involve other risks. All maintenance work must be carried out by authorised staff, except where specified in this manual.
- Unplug the device from the mains and contact qualified staff for assistance in one of the following cases:
  - The device has come into contact with water or liquids of any kind.
  - The device has been exposed to the elements.
  - A malfunction persists despite all the installation and/or maintenance procedures have been performed properly.



**IMPORTANT** The installer and the user, when using the JONIX minimate device, must take into account and solve all the other types of risk associated with the system. For example, risks arising from foreign bodies getting into the device or risks due to dangerous flammable or toxic gases at high temperature.

## 6.2 GETTING STARTED



- Check that the various components of the device are fully intact.
- Check that the documentation and any accessories for installation are contained in the package.



- Carry the device in its packaging as close as possible to the installation site.
- Do not rest weights or tools on the device, or place it on an unstable surface.

## 6.3 CHOOSING THE INSTALLATION SITE

The packed device is fixed on a pallet with some screws. Once brought to the installation site, it has to be unscrewed from the pallet before proceeding with the installation.



Get the appropriate tools to lift and unpack the device.



- Do not put the device in places where there are flammable gases, acidic, aggressive and corrosive substances that can damage the various components beyond repair.
- Provide a minimum clearance, in order to install the device and carry out routine and special maintenance.

### 6.3.1 Guidelines for wall mounting

Also a version of the device to be wall mounted is available.



**Before installation:**

- Check that under and above the device there is sufficient space in order to allow the air to flow.
- Make sure that the holes are aligned; in this respect, follow the quotas mentioned in the drawing to the side.

Drill holes in the wall and insert the screw anchors into them. Screw the screws allowing them to project 8-10 mm from the wall. **Check that the device is stable before using it.**

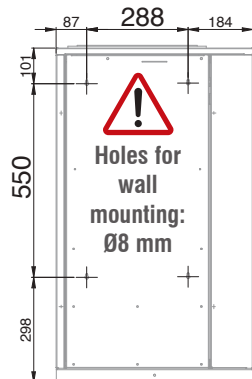

**The right plugs for installation must be chosen based on the weight of the appliance, shown in chap. " Technical data", and the type of wall it is installed on.**

Fig. A: Open completely the frontal panel.

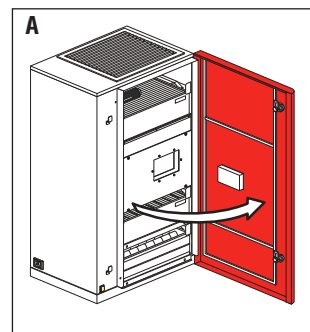

Fig. B: Remove the upper panel with the outer mesh.

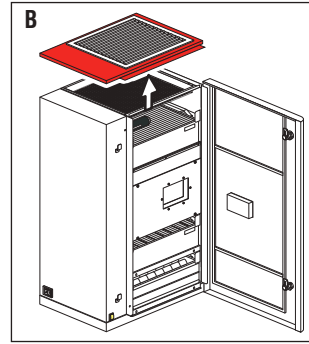
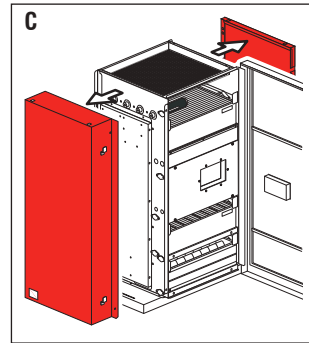
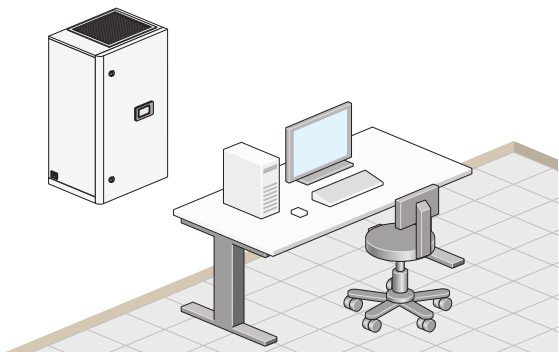

Fig. C: Remove the two side panels that give access to the pre-punched slots.  
At this stage it is possible to lift and fix the device to the wall.



**ATTENTION:** Due to the size and weight of the device, make sure that for handling a sufficient number of people is available, so that the weight to be loaded by each person is not more than 25 kg in the case of manual handling (in this regard, check the weight on Chapter "Technical data").

After the fixing, proceed eventually to reassemble the panels following the opposite sequence (C-B-A).



## 6.3.2 Guidelines for floor-mounting

Use the given screws and screw the 4 pirouetting wheels with brake, fixing them in the indicated holes placed on the bottom of the device.

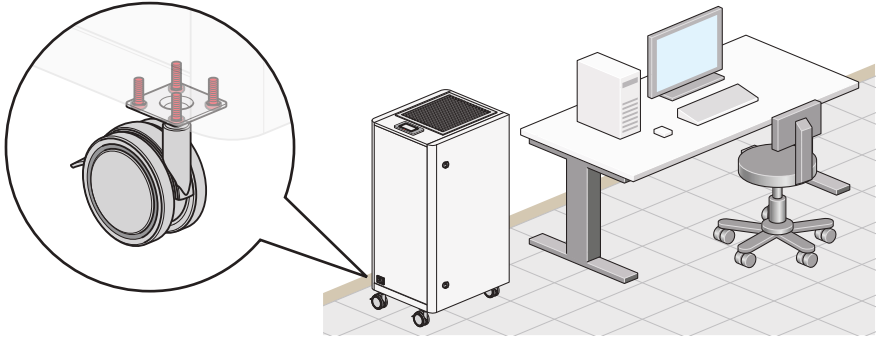

## 6.4 ELECTRICAL CONNECTIONS

---



**ATTENTION! BEFORE STARTING ANY OPERATION, MAKE SURE THAT THE MAIN POWER SUPPLY IS DISCONNECTED!**

- The electrical connections must be carried out following the instructions provided in this manual.
- **Make sure that voltage and frequency of the electric line correspond to those provided on the name plate.**



**WARNING!**

**Using power supply that does not meet the requirements requested by the device could resolve in damaging the device or part of it.**

- The electrical mains of the JONIX<sub>minimate</sub> device must be used for the device only, there must be no other devices powered by the same power line. Do not use adapters, power strips and/or extension cords.
- Make the connection with cables with a suitable cross-section and in compliance with local standards.
- **The installer must see to it to assemble the device as close to the power disconnector as possible, according to standards in force and as far as necessary to protect the electrical parts.**

## 6.5 ELECTRIC POWER SUPPLY

---

The JONIX<sub>minimate</sub> device leaves the factory fully wired. It only needs to be plugged into the electric mains, 230V/ ~1/ 50Hz. The unit is provided with power cord with Schuko plug.



The user has to provide a differential circuit breaker upstream in compliance with current norms. The protection fuse is installed on the panel.



**Before making any connections, make sure the mains voltage complies with what is shown on the label.**

The ON/OFF switch (in the below the lateral panel), indicates when the device is powered.

## 6.6 USING THE DEVICE

Fig. 01: Connect the device to the mains using the power cable provided.

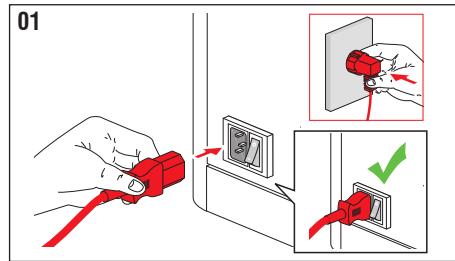
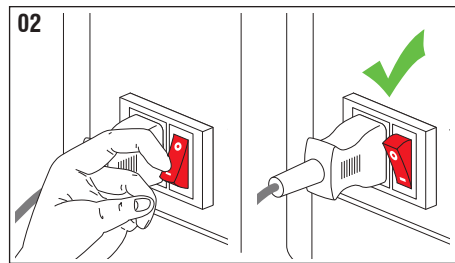

Fig. 02: Once connected to the mains supply, the JONIX<sup>minimate</sup> module is ready to work. In order to turn on the device act on the red switch **0/I** turning it to **I**. The switch lights up, indicating that the device is on and a slight hissing sound indicates that the condensers have started running.



The control and the setting of functions is set using the Display (see chap. "Technical Data" and "User interface and menu navigation").



### WARNING!

**it will take some minutes for the display to load the software correctly. When the device is turned on the display might appear to be turned off.**

## 6.7 DEFAULT SETTINGS

The module is set with the following default parameters:

Air flow rate (m <sup>3</sup> /h)	No. of ionising modules on
1000	2

## 6.8 USER INTERFACE AND MENU NAVIGATION

JONIX<sub>minimate</sub> is provided with a touch screen, allowing the user to control device status and to modify its operation as needed.

### 6.8.1 Main screen

It allows to check quickly the device status and to modify its operation mode.

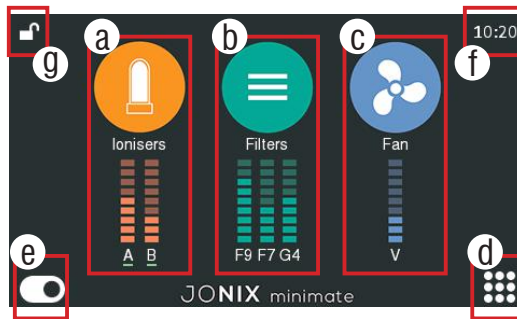

The various icons create a shortcut to other screens where the user can check the status of every single component in a more detailed way and its own personalization as needed.

In the main screen are reported this information:

- a) **Ionising modules:** the bars show the wear status of the ionisers ("a", "b"). When the cleaning of the ionizing tubes will be needed, or once the bars will be filled to indicate that the ionizing tube has to be replaced, an alarm notification will appear on the icon. Under the name of the correspondent module there is a green bar signalling that the module is turned on.
- b) **Filters:** the bars show the level of filth of the corresponding filter (G4, F7 or F9/H13). When the bars will be filled, which indicates that the filter has to be replaced, an alarm notification will appear on the icon.
- c) **Fan:** the bar show the airflow rate of the fan.
- d) **Settings.**
- e) **On/Off button:** it allows to change the operating status of the device.
- f) **Time.**
- g) **Lock screen button:** it is possible to lock the screen of the JONIX<sub>minimate</sub> device by clicking on the specific button with a lock on it, placed in the upper left corner of the screen.



Once the screen is locked it will not be possible to carry out any action without entering the password to unlock.

## Alarms notifications and alarms screen:

When the Jonix will notice that the user intervention is needed, this alert state will be shown with the appearance of a notification on the icon of the device part that has caused the alarm.



Alarm

Touching the "alarm" notification the user will be sent to the active alarms screen to see the notification detail:



To solve the problem displayed read the chap. "MAINTENANCE" or "OPERATIONAL CHECK AND TROUBLESHOOTING" of this manual.

**Touch the RESET button to delete the notification when the problem has been solved.**



## Buttons incorporated on the display:

All the following screens have on the bar in the inferior part of the display:

- a) "<" **button**: allows to go back to the previous screen.
- b) "i" **button**: allows to see the technical information of the equipment (software version and qr code for website link)

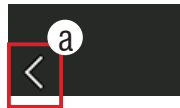

## 6.8.2 Ionisers screen

It displays the detailed status of the modules and allows the management of each of them according to the user needs.

- a) **On/Off button:** it turns on/ off the corresponding module. **Attention: when the time slots are activated, the buttons are disabled. To make them usable again, disable time slots.**

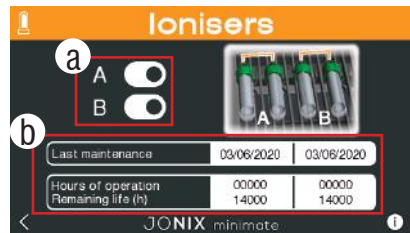

- b) **Module status summary:**

- Last maintenance: it reports the date when the last cleaning or replacement operation on the corresponding module was recorded.
- Hours of operation: it reports the total amount of hours of operations of the corresponding module.
- Remaining life (h): hours left before replacing the ionising tubes.

## 6.8.3 Filters screen

Shows a more detailed filters status.

- a) **Filters status summary:**

- Last replacement: shows the last time that the corresponding filter was replaced.
- Pressure drop: shows the pressure drop measured on the corresponding filter by the sensors.
- % Saturation Level: shows the percentage saturation rate of the corresponding filter. Once the 100% is reached the filter replacement becomes necessary. **ATTENTION: this number could not be equal to zero even when the filter is new.**
- Air volume treated: total air volume filtered from the last filter replacement.

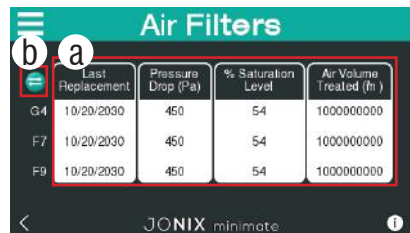

- b) **Selection button:** allows to modify the selection of F9 filter with H13 filter.

## 6.8.4 Fan screen

Shows a more detailed fan status and allows the management of its operation status as needed.

- a) **Air flow rate set:** through the buttons “-“ and “+“ the flow rate can be set in a range between 400 and 2000 m<sup>3</sup>/h with an increasing / decreasing step of 100 m<sup>3</sup>/h. **Attention: when the time slots are activated, the buttons are disabled. To make them usable again, disable time slots.**

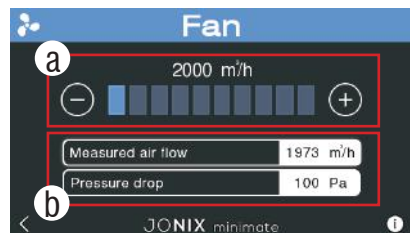

- b) **Fan status summary:**

- Measured air flow: it is the real time measurement of the air flow of the fan (from the appropriate sensor).
- Pressure drop: it is the real time measurement of the pressure drop on the fan (from the appropriate sensor).

## 6.8.5 Settings screen

It shows all the sets of parameters of the device.



### 6.8.5.1 Date and time

Date and time can be set by touching the buttons “+” and “-”.



### 6.8.5.2 Language

The user can set the language of the text on the display from this screen. The white icon shows which language is used in that moment; touch another icon to modify it.



### 6.8.5.3 Display

The brightness of the display can be modified using the buttons “+” and “-”.



## 6.8.5.4 Protection

Set the authorizations management to check the device.

- a) **User Password:** to log in, touch the symbol “\*\*\*\*”, insert the password on the keyboard and push the Enter button to confirm or the Esc Button to cancel the operation. Touch the confirmation button (green tick) to confirm the password, or the cancel button (red cross) to cancel the operation.



**The password of the device JONIX minimate is: 100**

It is possible to modify the password holding the button to the side of the currently set password.



- b) **Change confirmation is required:** the operating system requires a confirmation, touching a button, on every action that can modify the device operating status.
- c) **Password is always required:** the operating system requires a password to perform every action that can change the device operating status. Once the password is inserted, the system keeps the user activated for 10 minutes. After that period the password must be reinserted.



If the user wants to logout before the 10 minutes have elapsed, he can touch the logout button that will pop up in the settings screen after the login.



The actions that can be protected with password are:

- Device On/Off.
- Ionising modules On/Off.
- Increase/decrease of the fan speed.



**In case of change of password it is recommended to save the new password in a readily available support.**

The screens that are protected with password regardless the protection level set are:

- **Protection**
- **Time slots**
- **Maintenance**

## 6.8.5.5 Time slots

Up to 4 time slots for every day of the week can be set.

- a) **Enable / disable time slots mode.**
- b) **Setting the time slots mode:** allows to access the screen with time slots setting.

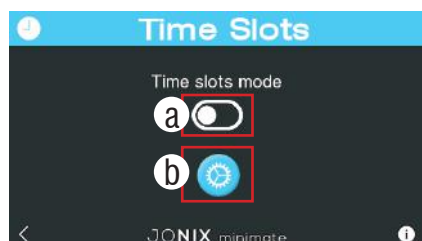

After pressing on the button setting the time slots, the following screens will appear:

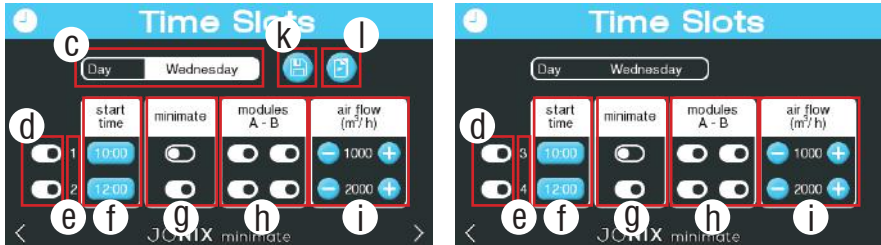

- c) **Day:** day of the week selected. Every time slot is defined by different parameters:
- d) **Enable / disable time slots mode.**
- e) **Time slot number:** for each day of the week it is possible to set up to 4 time slots.
- f) **Start time:** start time of the time slot.
- g) **minimate:** enable / disable JONIX minimate.
- h) **Modules A - B:** enable / disable the ionising module (A - B).
- i) **Air flow (m<sup>3</sup>/h):** set up of the fan airflow.



**The setting of the start time of the next slot (in the same day or in another) implies the end of the previous time slot.**

- l) **Copy button:** allow to copy the time slots of a day in one or more different days. Touching the button, a dialog box will appear where must be chosen the day from which the slots will be copied and the day in which they will be copied. Once the operation will be confirmed, the day displayed will be changed in the one in which are just been copied the time slots.



**NOTE:** it is possible to copy the slots in one single day for time. To copy the slots in more days this action must be repeated.

- k) **Save button:** when the user begin to modify a time slot, this button appears to apprise that a modification to the previous settings is occurring and needs to be saved in the memory of the system. When the saving operation is successfully finished the button disappears.



**NOTA:** it is always necessary to save before changing the day (using the menu in the box b) or leave the menu. If not, the modification will be lost.



If only one time slot is set or enabled, the device will operate with the parameters set in that slot until it will be disabled or will be added another slot.



**When time slots are enabled it is not possible change the operating status of the ionising modules or the air flow rate of the fan in their corresponding screens (6.8.2 and 6.8.4).**

## 6.8.5.6 Maintenance

Maintenance screens of the ionising modules and of the filters are accessible from this screen.

- a) Access to the menu "Ionisers Maintenance".
- b) Access to the menu "Filters Maintenance".



### Ionisers Maintenance

Allows to record the date when a maintenance operation was done on the ionising modules (A - B).

- a) **Cleaning:** records the cleaning operation.
  - b) **Replacement:** records the substitution operation.
- After pressing one of the keys, a message of confirmation of the recording by the system of the maintenance operation that was done will appear.

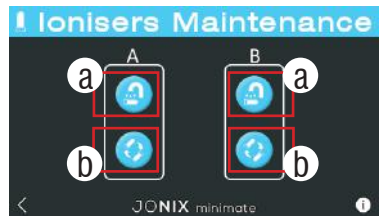

**NOTE:** The operation does not represent the maintenance of the components but only the recording of the system of the intervention carried out by the user. The maintenance procedures are explained in the chapter "Maintenance" of this manual.

### Filters Maintenance

Maintenance operations on the corresponding filter can be recorded in the system from this menu.

- a) Filter F9 (or H13).
- b) Filter F7.
- c) Filter G4.

After pressing one of the buttons, a message of confirmation of the record by the system of the maintenance operation that was done will appear.

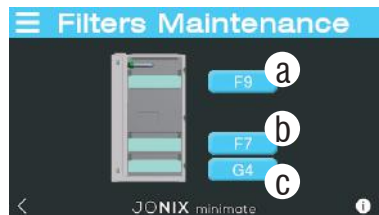

**NOTE:** The operation does not represent the maintenance of the components but only the recording of the system of the intervention carried out by the user. The maintenance procedures are explained in the chapter "Maintenance" of this manual.



### 6.8.5.7 Alarms History

Shows the list of all the alarm messages displayed from the device in the set time lapse.



### 6.8.5.8 Configuration

- a) **Advanced configuration:** restricted menu for technical support, not accessible to the final user.



### 6.8.5.9 Multimedia screen

Shows the links to all the multimedia content installed on the system.

- a) **Picture:** allows to view photographic content.
- b) **Video:** allows to view video contents.



NOTE: if multimedia content is not present, the icons are obscured.



## 7 - MAINTENANCE

### 7.1 WARNINGS



**BEFORE CARRYING OUT ANY MAINTENANCE OPERATION MAKE SURE THAT THE DEVICE IS NOT AND CANNOT ACCIDENTALLY BE POWERED ELECTRICALLY. YOU MUST THEREFORE UNPLUG THE DEVICE BEFORE CARRYING OUT ANY MAINTENANCE.**

- It is the duty of the user to perform all the maintenance operations on the device listed below.
- If you experience a malfunction, unplug the device from the mains and contact qualified staff (retailer, the Manufacturer).
- Only trained and qualified personnel can perform maintenance operations.



**Use work gloves to protect your hands when performing maintenance.**

The frequency of the operations to be performed to ensure proper maintenance of the device JONIX<sup>minimate</sup> depends mainly on the quality of the treated air.

Air can be especially harmful for condensers when it contains polluting or aggressive substances such as:

- Industrial flue gas
- Sale
- Chemical smoke
- Heavy powders



**By coming into contact with the inside or outer surfaces of the device by means of the air flow or by direct exposure, these substances can lead to a structural and functional failure of the device and of its performance as time passes and without proper, systematic maintenance.**

### 7.2 ROUTINE MAINTENANCE

The JONIX<sup>minimate</sup> device requires a small amount of maintenance consisting in regularly cleaning of cold plasma generators and checking the filters.

JONIX<sup>minimate</sup> device, signals the need of maintenance of the modules through an alarm viewed on the display, every 1000 hours of operation. Filters do not need to be cleaned periodically but will need to be changed when they reach saturation.

However, when operating in highly contaminated environments, the electronics of the device could intervene even if this time has not yet elapsed.

## 7.2.1 Cleaning the Ionising Tubes



Clean the ionising tubes every time it is shown on the display.

Fig. 03: Switch the device off by turning the luminous On/Off switch to **0**. Remove the plug connected to the mains.

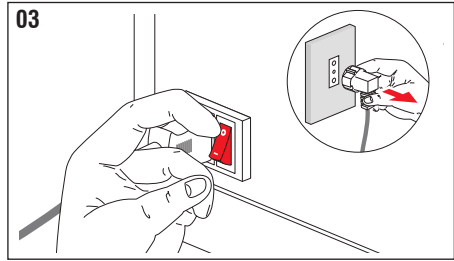

Fig. 04: Open with the handle the anterior door to access the ionising tubes.

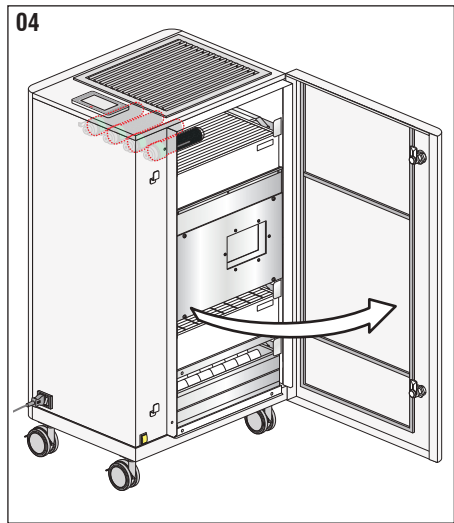

Fig. 05: Gently unscrew the tubes, using the green plastic base. If you have trouble, first pull off the outer mesh.

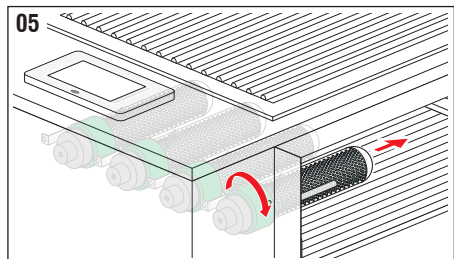

Fig. 06: Pull off the outer mesh from the tube if you have not already done so in the previous point.  
If this is difficult to do, turn the mesh around the glass while pulling to remove it.

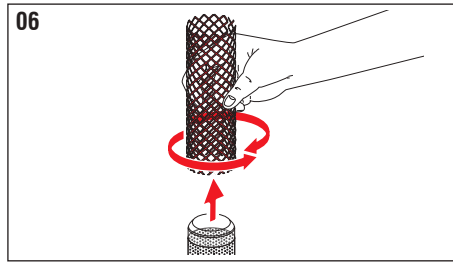
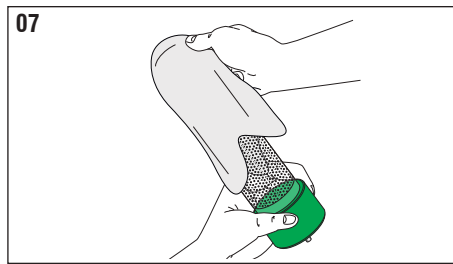

Fig. 07: Clean the glass using a damp cloth.



**Do not use liquid cleaners or sprays, soap or the like.**



Check that the tube is in good conditions: there must not be any cracks or other damage; otherwise it must be replaced. As soon as you notice a whitish layer on the perforated metal plate inside the glass it means that the ionising tube needs replacing.

**The tubes must usually be replaced within 18 months of use.**

Fig. 08: Wash the mesh under running hot water and dry it thoroughly with a cloth.



**Do not put back the mesh on the ionising tube if it is even partially wet.**

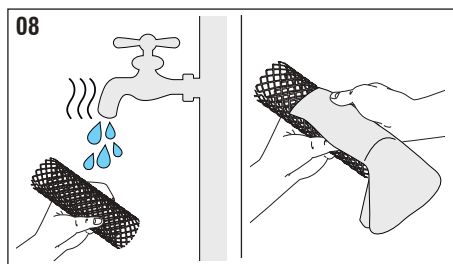

Fig. 09: Put the outer metal mesh back on the glass tube so that it fully overlaps the internal plate.



**In any case ensure a minimum distance of at least 3 mm from the base of the tube.**

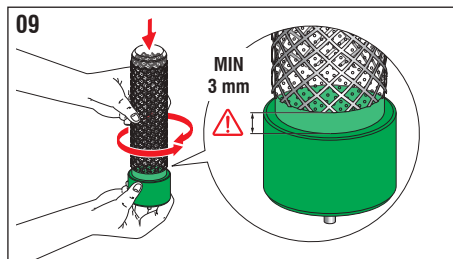

Fig. 10: Gently screw the ionising tube holding on to the base (green part). If the operation is difficult to perform, pull slightly the earthing spring so that it is not in contact with the surface of the tube.

**ATTENTION:** do not overtighten the screw after reaching its end stop.



Check that the earthing spring is in contact with the outer mesh once the ionising tubes have been screwed back into place. Otherwise contact the manufacturer.

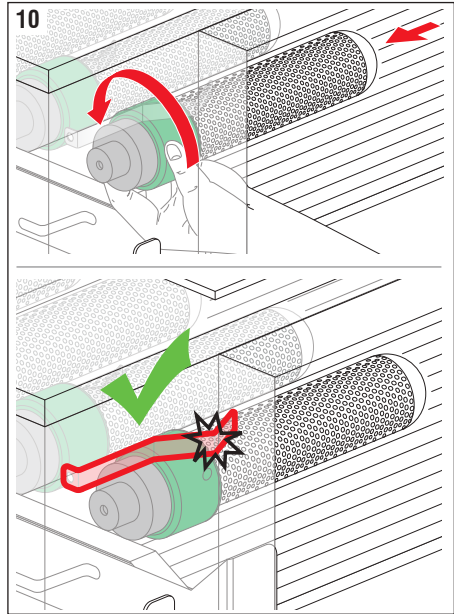
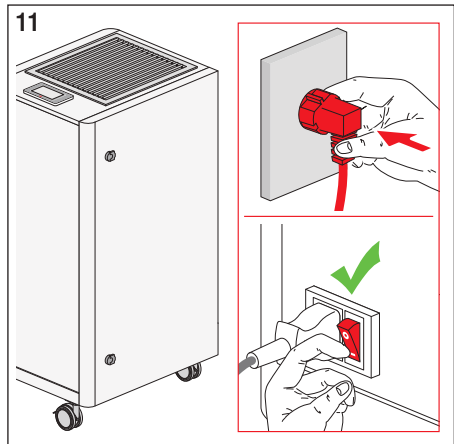
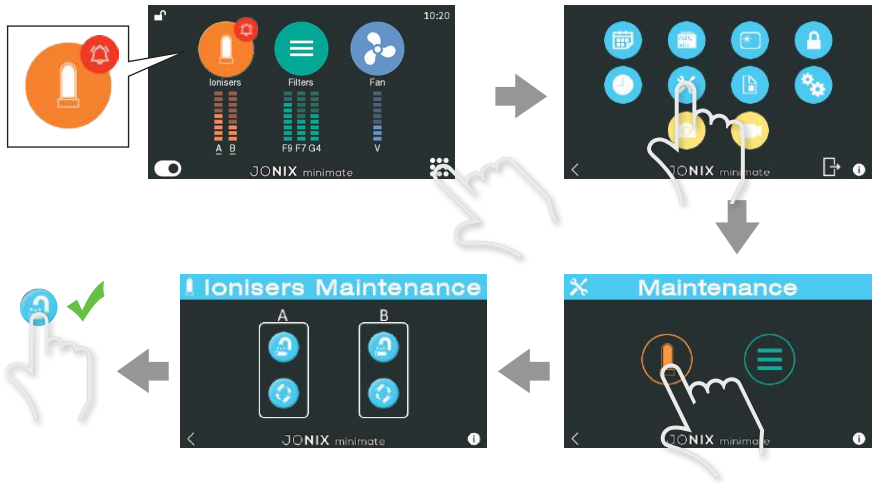

Fig. 11: Close the anterior panel. Switch the device on by turning the On/Off switch to I.



Register the maintenance operation done using the display:



Reset the alarm launched by the device in the alarm screen:

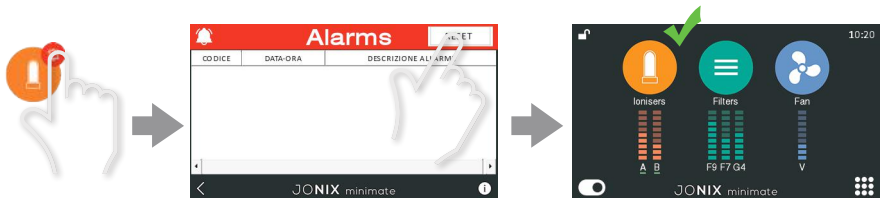

Make sure the condensers work properly: you must be able to hear a slight hissing. Check that the device responds to commands. Should a malfunction persist, unplug the device from the mains and contact qualified staff.

**Failure to clean the ionising tubes when indicated by the device leads to a drop in system performance.**

## 7.2.2 External cleaning of the equipment

Clean the outside of the device with a damp cloth.



**Do not use liquid cleaners or sprays, soap or the like.**

### 7.3 SPECIAL MAINTENANCE

The components of the device subject to time deterioration hence they need to be replaced are:

- ionising tubes: when signs of wear appear, it is necessary to replace the component. They are evident with the appearance of oxide in the condenser internal mesh that will make it whitish, and that will render the glass opaque. The device will signal the need of replacement of the component after 14000 hours of operation.
- filters: the components have the function of barrier, and they tend to saturate so that eventually they will obstruct the air flow. The detection devices internal to JONIX minimate signal how necessary is an operation of replacement in order to maintain a smooth functioning of the device.

#### 7.3.1 Replacing the ionising tubes



**Replace the ionising tubes every time it is notified on the display.**

Fig. 12: Switch the device off by turning the luminous On/Off switch to **O**.  
Remove the plug connected to the mains.

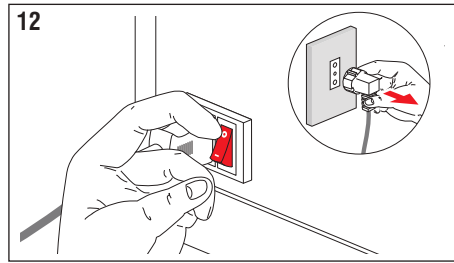

Fig. 13: Open with the handle the anterior door to access the ionising tubes.

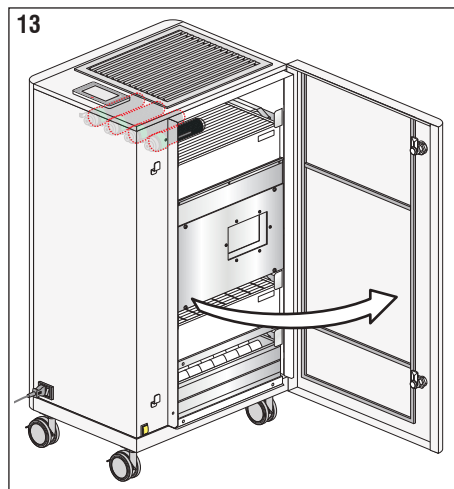

Fig. 14: Gently unscrew the tubes, **using the green plastic base**. If you have trouble, first pull off the outer mesh.

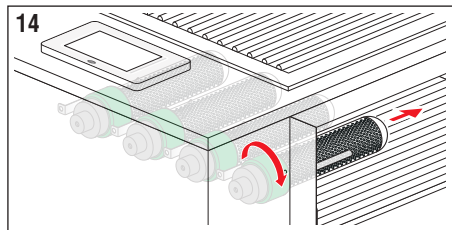

Fig. 15: Screw delicately the ionising tube holding on to the base (green part). If the operation is difficult to perform, pull slightly the earthing spring so that it is not in contact with the surface of the tube.

**ATTENTION: do not overtighten the screw after reaching its end stop.**



**Check that the earthing spring is in contact with the outer mesh once the ionising tubes have been screwed back into place. Otherwise contact the manufacturer.**

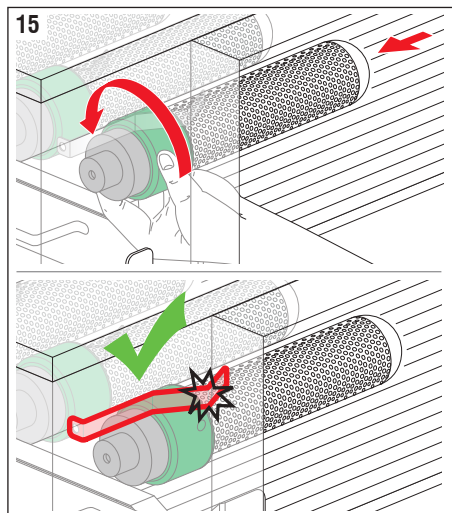
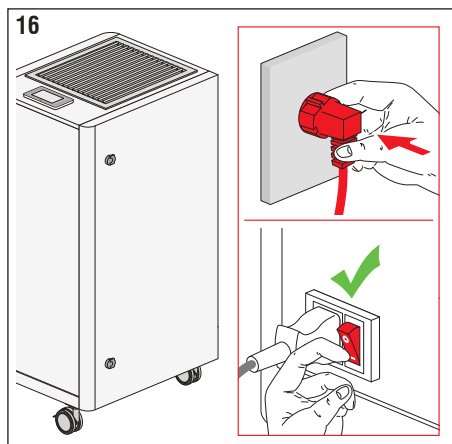
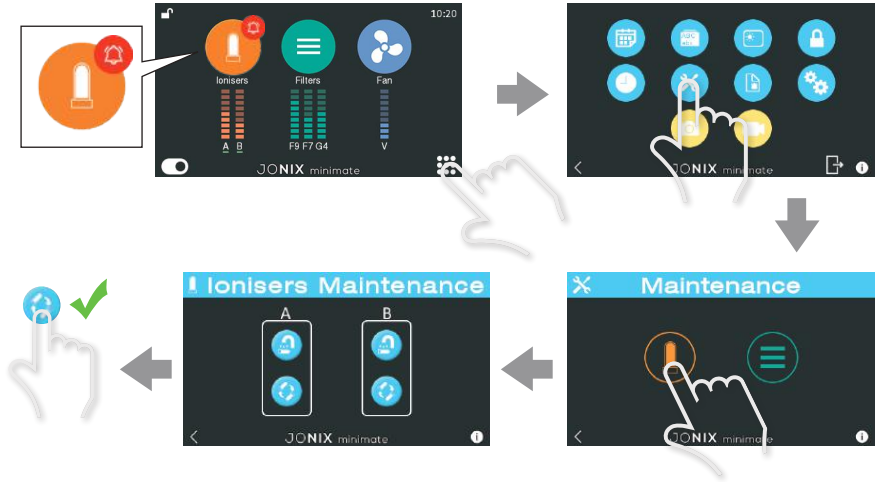

Fig. 16: Close the anterior panel. Switch the device on by turning the On/Off switch to **I**.





Register the maintenance operation done using the display:



Reset the alarm launched by the device in the alarm screen:

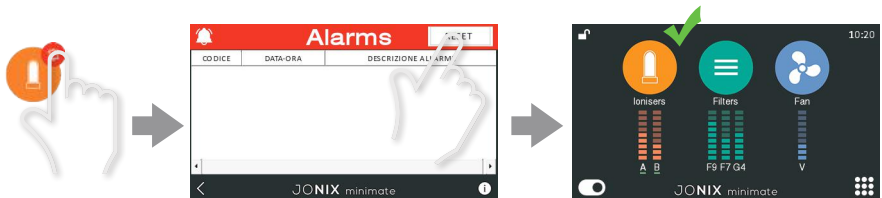

Make sure the condensers work properly: you must be able to hear a slight hissing. Check that the device responds to commands. Should a malfunction persist, unplug the device from the mains and contact qualified staff.

**Failure to replace the ionising tubes when indicated by the device leads to a drop in system performance.**

## 7.3.2 Replacing filters



Replace the ionising tubes every time it is notified on the display.

Fig. 17: Switch the device off by turning the luminous On/Off switch to **0**.

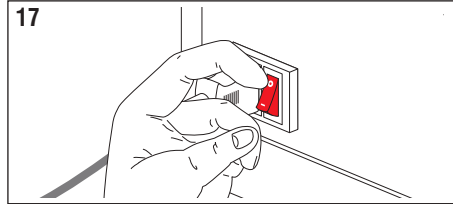

Fig. 18: Open with the handle the anterior door to access the filters.

Type of filters:

- a) Thin particulate filter **F9** (or **H13**)
- b) Thin particulate filter **F7**
- c) Prefilter particulate coarse **G4**



**NOTE: periodically verify the status of the G4 filter ("c"), regardless of the indications on the display, mostly in dusty environments.**

**In case it has filth and it is not yet time to replace it, clean it using a vacuum cleaner.**

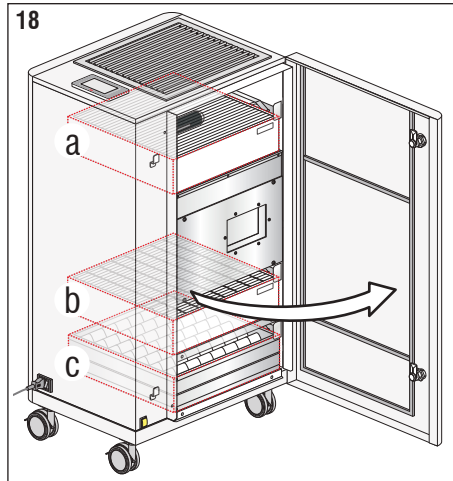
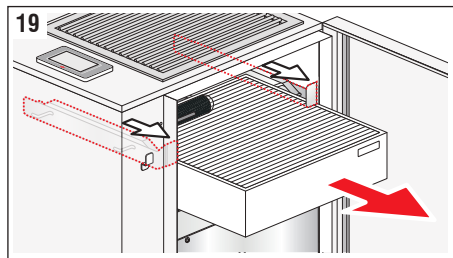

Fig. 19: Pull the filter locking tabs out. Extract the filters.



**NOTE: the dirty filters which cannot be used anymore must be disposed of according to the indications in the chapter "DISPOSAL." F9, F7 and G4 filters are industrial waste.**

Fig. 20: Put the new / clean filters back in place. Push the filter locking tabs towards the device until they click.

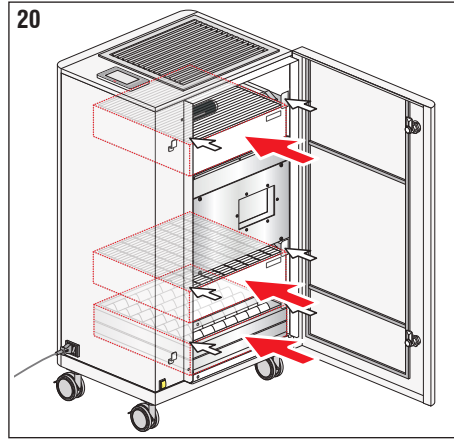
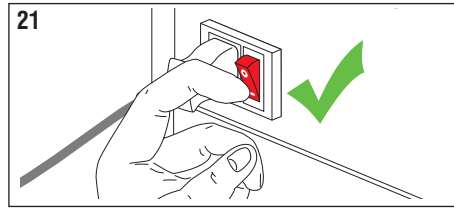
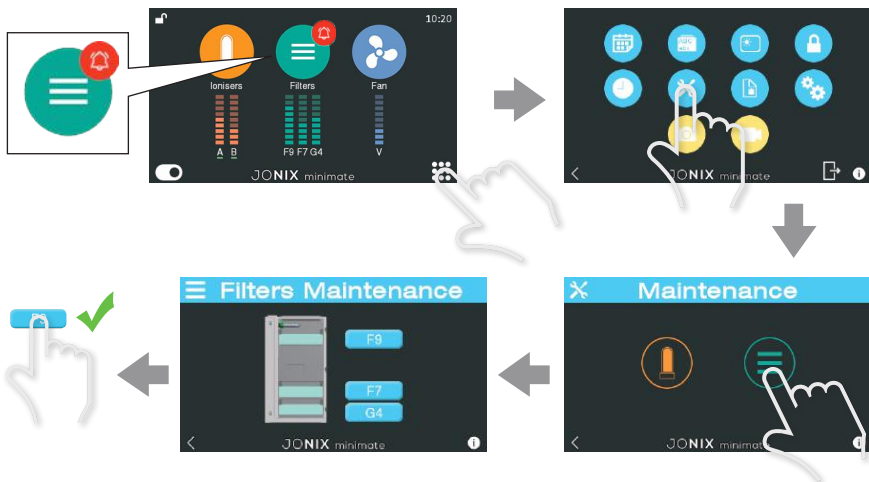

Fig. 21: Close the anterior panel. Switch the device on by turning the On/Off switch to I.



### Register the maintenance operation done using the display:



Reset the alarm launched by the device in the alarm screen:

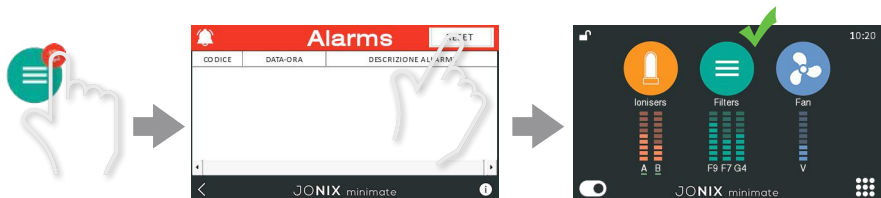

## 8 - OPERATIONAL CHECK AND TROUBLESHOOTING

This section summarises the most common problems that may arise when using the unit. Before contacting customer services, carry out the checks listed below.

PROBLEM	POSSIBLE CAUSE	SOLUTION
Alarm for filter with filth.	The sensors associated to the filter detect a pressure drop that is too high between inlet and outlet of the filter.	The filter must be replaced. Follow the procedure in paragraph 7.3.2.
Alarm maintenance ionising module.	The system detects the need of cleaning the ionising module.	The tubes of the ionising module related to the alarm have to be cleaned. Follow the replacement of the ionising tubes procedure in paragraph 7.2.1.
Alarm for the replacement of the ionising module.	The system detects the need of replacing the tubes for the ionising module.	The tubes in the ionising module related to the alarm must be replaced. Follow the replacement of the ionising tubes procedure in paragraph 7.3.1.
Alarm ionising module.	The system detects an irregularity in the operation of the ionising module.	The tubes of the ionising module related to the alarm must be cleaned or replaced. Follow the cleaning procedure; in the event that the alarm continues, follow the replacement procedure for the ionising tubes in paragraph 7.3.1.



**In the event that you experience a malfunction other than those described above contact qualified staff (retailer, Manufacturer).**

Unplug the device from the mains and contact qualified staff for assistance even in the event of one or several of the cases below:

- The power cable is damaged or worn.
- The plug is damaged or worn.
- Water or liquid has been poured onto the device.
- In the event that there is a malfunction despite all the installation procedures have been carried out properly.

## 9 - DISPOSAL

When JONIX minimate devices are no longer used they must be disposed of in compliance with the regulations in force in the country of installation. The unit consists of the following materials:

- Stainless steel.
- Aluminium.
- Glass.
- Nylon.
- Plastic.
- Paper and Cardboard.
- Wood.



The components subject to wear as F9, F7 and G4 filters are industrial waste.



### WASTE ELECTRICAL AND ELECTRONIC EQUIPMENT MANAGEMENT

This product falls within the application scope of the Directive 2012/19/EU concerning the management of waste electrical and electronic equipment (WEEE). Equipment must not be disposed of with household waste as it is made of different materials that can be recycled at special facilities. Please inquire through your municipal authorities as to the location of the eco-friendly waste management sites where waste can be received for disposal and its subsequent recycling as recommended. Furthermore, please note that, when an equivalent appliance is purchased, the seller is expected to collect free of charge the old product to be disposed of. The product is not potentially dangerous for human health and the environment, as it does not contain any harmful substances according to the Directive 2011/65/EU (RoHS), but if disposed of freely in the environment, it might adversely affect the ecosystem.

Read the instructions carefully before using the equipment for the first time. It is strongly recommended not to use the product for any purpose other than that for which it was designed, to prevent the risk electric shock if the product is used incorrectly.

## NOTES

.....

.....

.....

## WARRANTY CONDITIONS

The Manufacturer guarantees the repairs of the systems that you have purchased and that are distributed throughout the country, in the event that the system shows signs of faulty materials or incorrect manufacture, subject to the following conditions:

1. The warranty starts from the date of purchase and lasts for 12 months.
2. No warranty is provided for the breakage of the ionising tube.
3. Failure to comply with operating and maintenance instructions contained in the manual attached to the device voids the warranty.
4. The purchaser has the right to benefit from the 12 month warranty only if the warranty certificate is filled in correctly in all parts and sent within 10 days of purchase to:

*JONIX S.r.l., Viale Spagna, 31/33 – 35020 Tribano (PD) Italy*

5. The warranty is only valid if the system is purchased from an authorised retailer.
6. The warranty includes free repair or replacement of the components which are faulty due to incorrect manufacture and does not include the replacement of the device under any circumstances.
7. Warranty repairs are carried out solely by the retailer or the manufacturer.
8. The warranty does not cover systems that are damaged or faulty due to: replacement of components or accessories with others of a type that is not explicitly approved by the manufacturer, interventions carried out by unauthorised or unqualified staff, non-compliance with the environmental conditions, neglect, lightning, floods, fire, acts of war, riots. Malfunctions due to incorrect installation are not covered.
9. The warranty does not cover systems with illegible, missing or altered serial numbers or labels.
10. To benefit from the warranty, the purchaser must contact the supplier, delivering the device at a later stage, accompanied by a document proving the purchase.
11. All transport costs and the relative risks are under the purchaser's responsibility.
12. Carrying out one or several repairs during the warranty period does not change the warranty expiry date.
13. The manufacturer disclaims any liability for any direct or indirect damage caused to people or property due to defects resulting from the product being used incorrectly.

The user authorises the manufacturer and related customer support services to store and use personal data in accordance with Italian Legislative Decree No. 196 dated 30/06/2003. In accordance with Art. 7 of Italian Legislative Decree No. 196/2003 you may exercise your rights at any time with regard to the data controller (JONIX srl).

**EC DECLARATION OF CONFORMITY**

**JONIX S.R.L.**

LEGAL SITE Viale Spagna, 31/33 – 35020 Tribano (PD)  
 SCIENTIFIC SITE Via Tegulaia 10/b - 56121 Pisa  
 OPERATIVE SITE Via Romagnoli, 12/A - 40010 Bentivoglio (BO)

**declares that  
 the following products**

<i>DESCRIPTION</i>	<b>Devices for active sanitation and air purification</b>	
<i>MODELS</i>	<input type="radio"/> <b>Cube</b> <input checked="" type="radio"/> <b>Mate - mini Mate</b> <input type="radio"/> <b>Steel</b>	<i>Select the model to which the declaration refers to</i>
<i>PRODUCT TYPE</i>	<input type="radio"/> <input type="radio"/> <input checked="" type="radio"/> <input type="radio"/>	<i>Select the model to which the declaration refers to</i>
<i>product code</i>	xxx	
<i>serial n°</i>	xxx	

**/ F U L F I L S**

**to the requirements of the Machinery Directive 2006/42/EC**

**reference standard**

EN 12100:2010  
 EN 60204-1:2016

**OTHER APPLICABLE DIRECTIVES**

2011/65/EU ROHS Directive  
 2014/30/EU EMC Directive (ex 2004/108/EC)  
 2014/35/EU LVD Directive (ex 2006/95/EC)

**reference standard**

EN 60335-2-65:2003/A11:2012

Household and similar electrical appliances. Safety. Particular requirements for air-cleaning appliances

*This declaration of conformity is issued under the total sole responsibility of the manufacturer*

General manager **Mauro Mantovan**

function



signature

**ATTACHMENTS**

**EXPLODED JONIX minimate (WHEELED VERSION)**

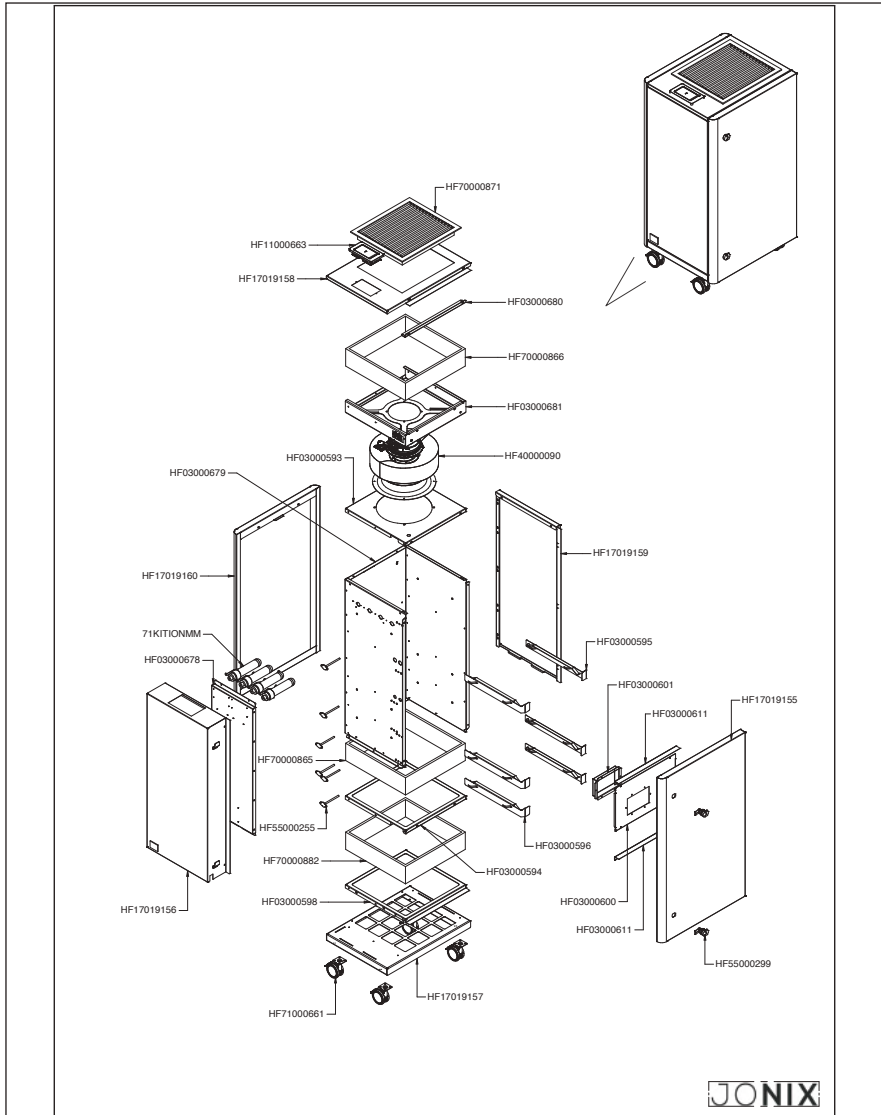



**EXPLODED JONIX** minimize (WALL MOUNTED VERSION)

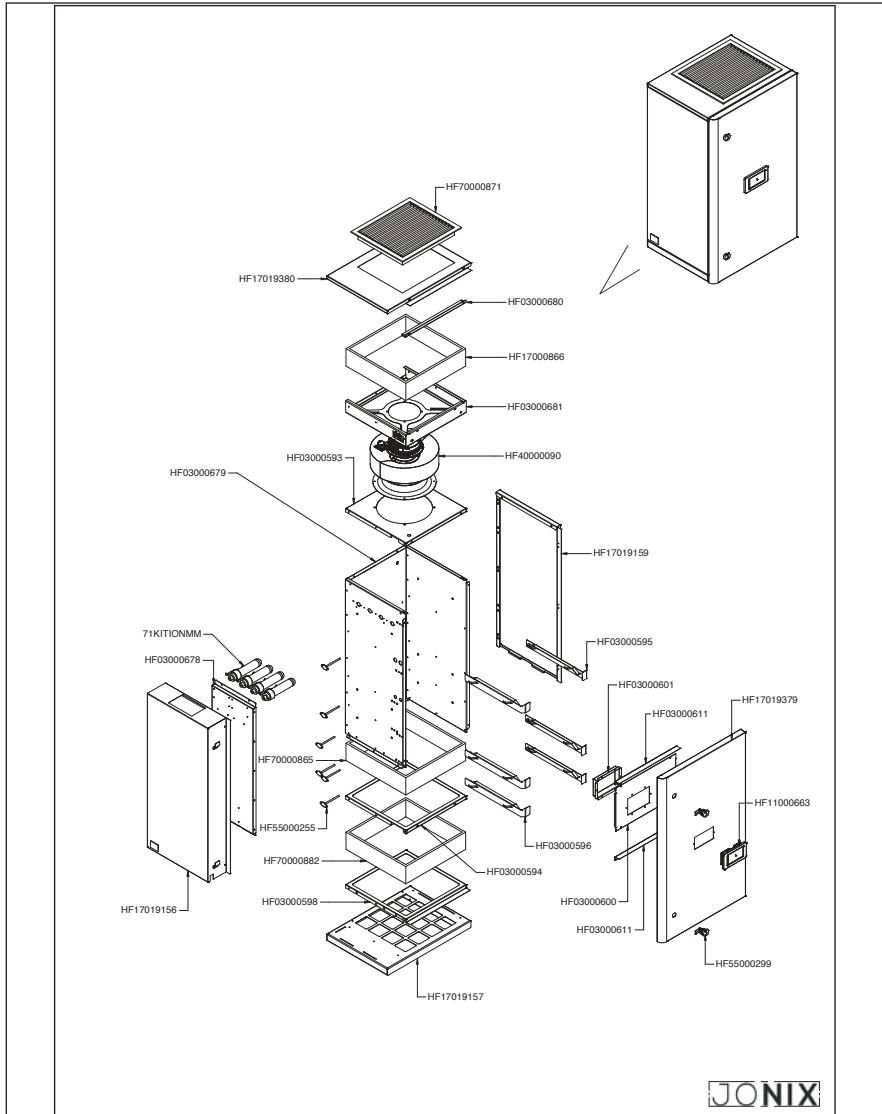

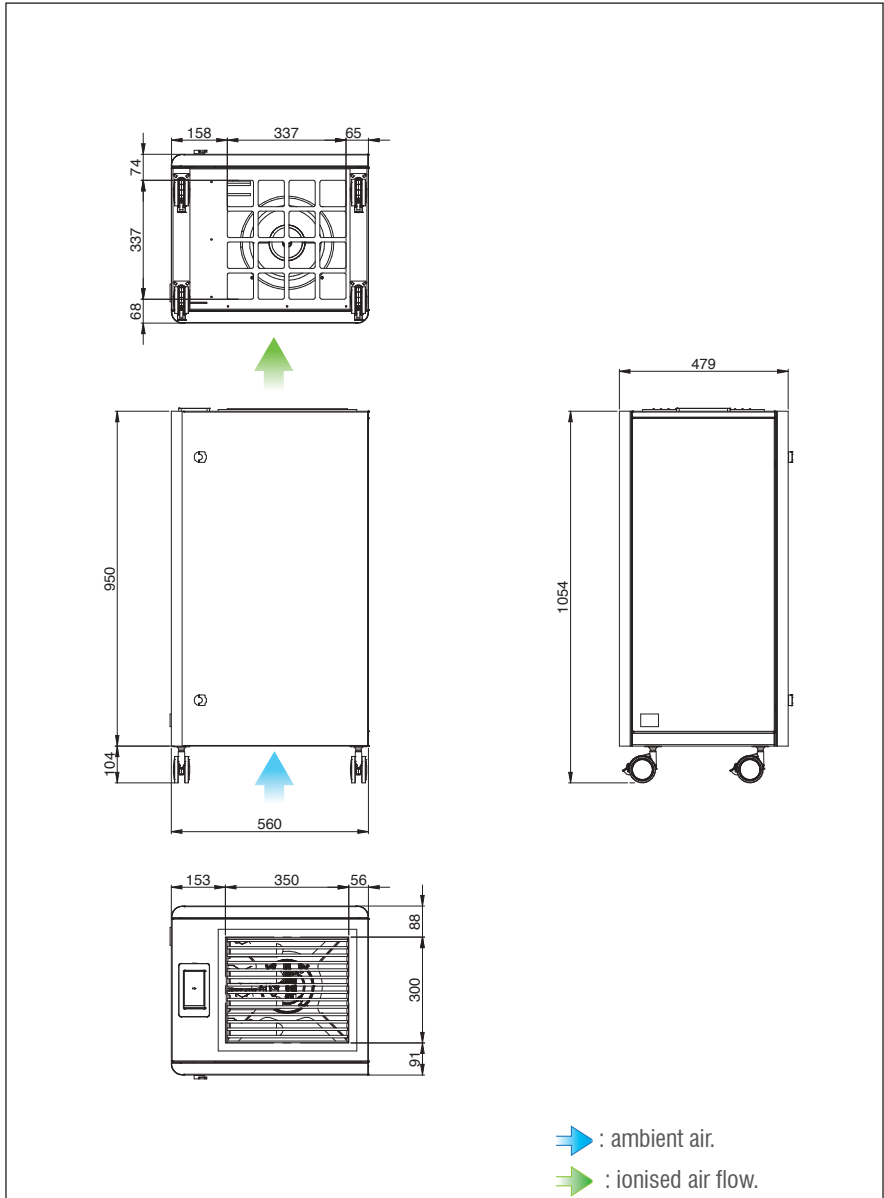

## OVERALL DIMENSIONS JONIX minimate (WHEELED VERSION)

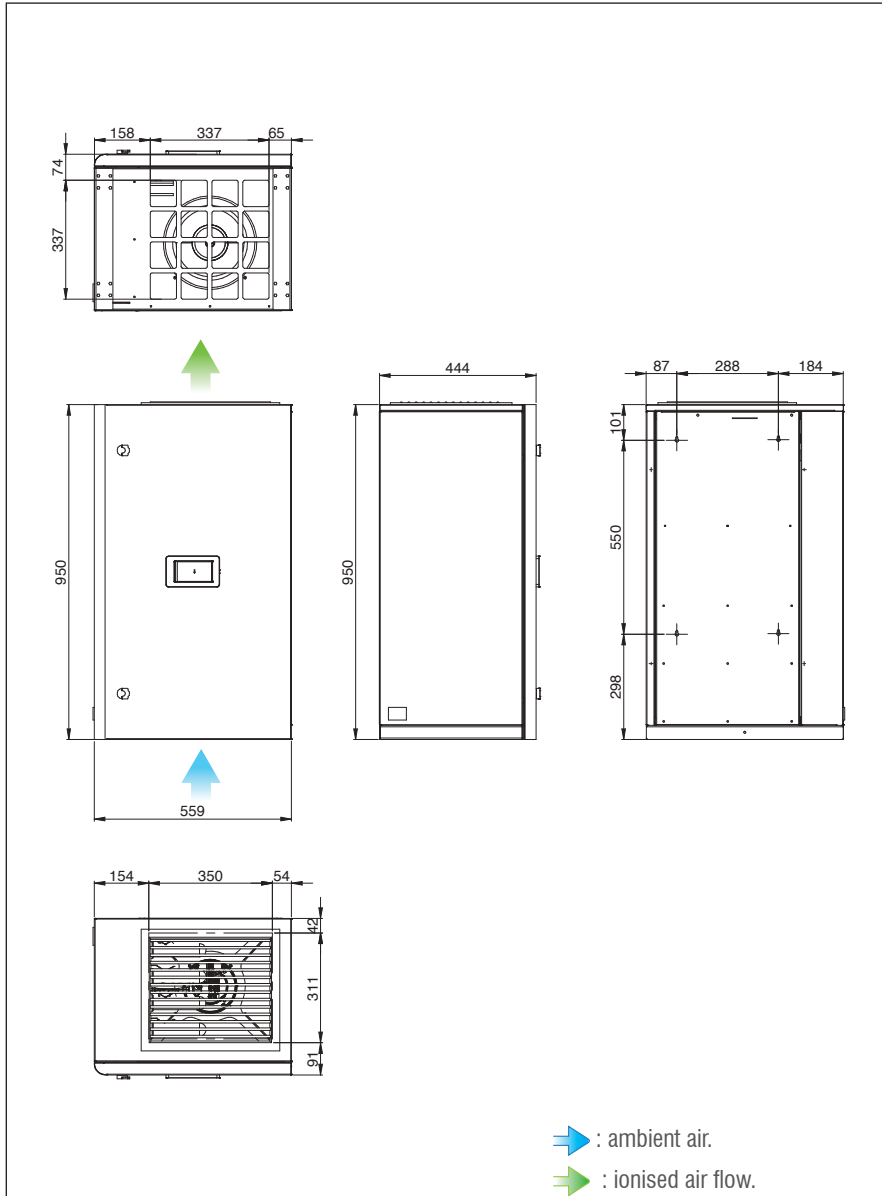

**OVERALL DIMENSIONS** JONIX *minimate* (WALL MOUNTED VERSION)



	Manufactured by HiRef. S.p.a. Viale Spagna, 31/33 35020 Tribano (Padova) Italy tel: ++39 049 9588511 fax: ++39 049 9588522 web: www.hiref.it e@mail: info@hiref.it							
Serie Model	MINIMATE 4							
Drawing code	HF620R3431		Controller		pC00EM+			
Power supply Auxiliary supply	230V/1~/50Hz+N 24VAC		- -					
Created by Date	DP1 07/03/2017		Revision by On		AD1 21/12/2017		Index C	
Max power (kW) FLA (A) LRA (A)	SEE TABLE ON PAGE 2 SEE TABLE ON PAGE 2 SEE TABLE ON PAGE 2							
Main protection	SEE TABLE ON PAGE 2							
REVISION DATE LAST C	DATE 07/03/2017 BY AD1 21/12/2017	DRAWN BY CHECKED AD1 APPR. TIME					MINIMATE 4	HF620R3431
TOTAL SHEET 19 CONTINUE 2 SHEET 1								

1	2	3	4	5	6	7	8																											
REFERENCE NORMATIVE EN 60204																																		
A	MODEL	OPERATION	POWER SUPPLY	MAX ABSORBED POWER (kW)	MAX ABSORBED CURRENT (A)	LRA (A)	MAIN SUGGEST PROTECTION 9G FUSE TYPE	MIN SUGGEST CROSS SECTION LINE (mm) VS MAX LENGTH (m) AIR TEMPERATURE 30°C - MULTICORE CABLE - CABLE INSIDE TUBE ON AIR																										
							CABLE WORKING TEMPERATURE 70°C	PVC INSULATED EPR (G7-G10) INSULATED																										
	MM4	/	LINE	0.56	2.48	/	10	CABLE WORKING TEMPERATURE 80°C 1.5 53.4 1.5 53.4																										
B																																		
C																																		
D																																		
E																																		
F	<table border="1" style="width: 100%; border-collapse: collapse;"> <tr> <td colspan="2">REVISION</td> <td colspan="2">DATE</td> <td colspan="2">DATE</td> <td colspan="2">DATE</td> </tr> <tr> <td>LAST</td> <td>BY</td> <td>DRAWN</td> <td>DPI</td> <td>CHECKING</td> <td>APPR.</td> <td>MM</td> <td></td> </tr> <tr> <td>C</td> <td>A01</td> <td></td> <td></td> <td></td> <td></td> <td></td> <td></td> </tr> </table>			REVISION		DATE		DATE		DATE		LAST	BY	DRAWN	DPI	CHECKING	APPR.	MM		C	A01									MINIMATE 4		HF620R3431	TOTAL SHEET 19 CONTINUE 3 SHEET 2	
REVISION		DATE		DATE		DATE																												
LAST	BY	DRAWN	DPI	CHECKING	APPR.	MM																												
C	A01																																	

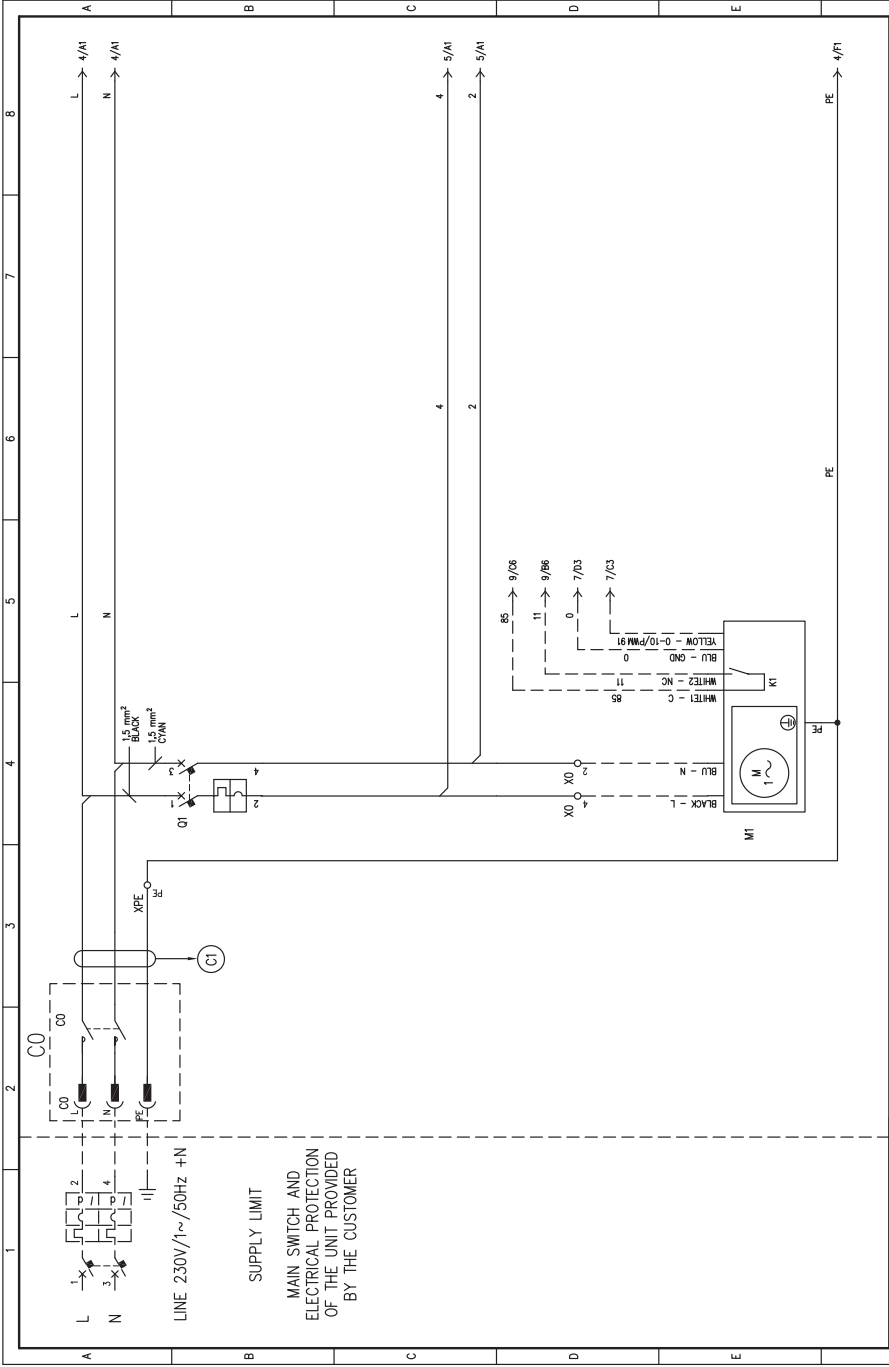

REVISION		DATE 07/03/2017	
LAST	BY	DRAWN	DF
C	A01	CHECKING	
		APPROV.	IMM
<b>JONIX</b>			
		MINIMATE	
		HFG20R3431	
TOTAL SHEET 19			4
CONTINUE			4
SHEET			3

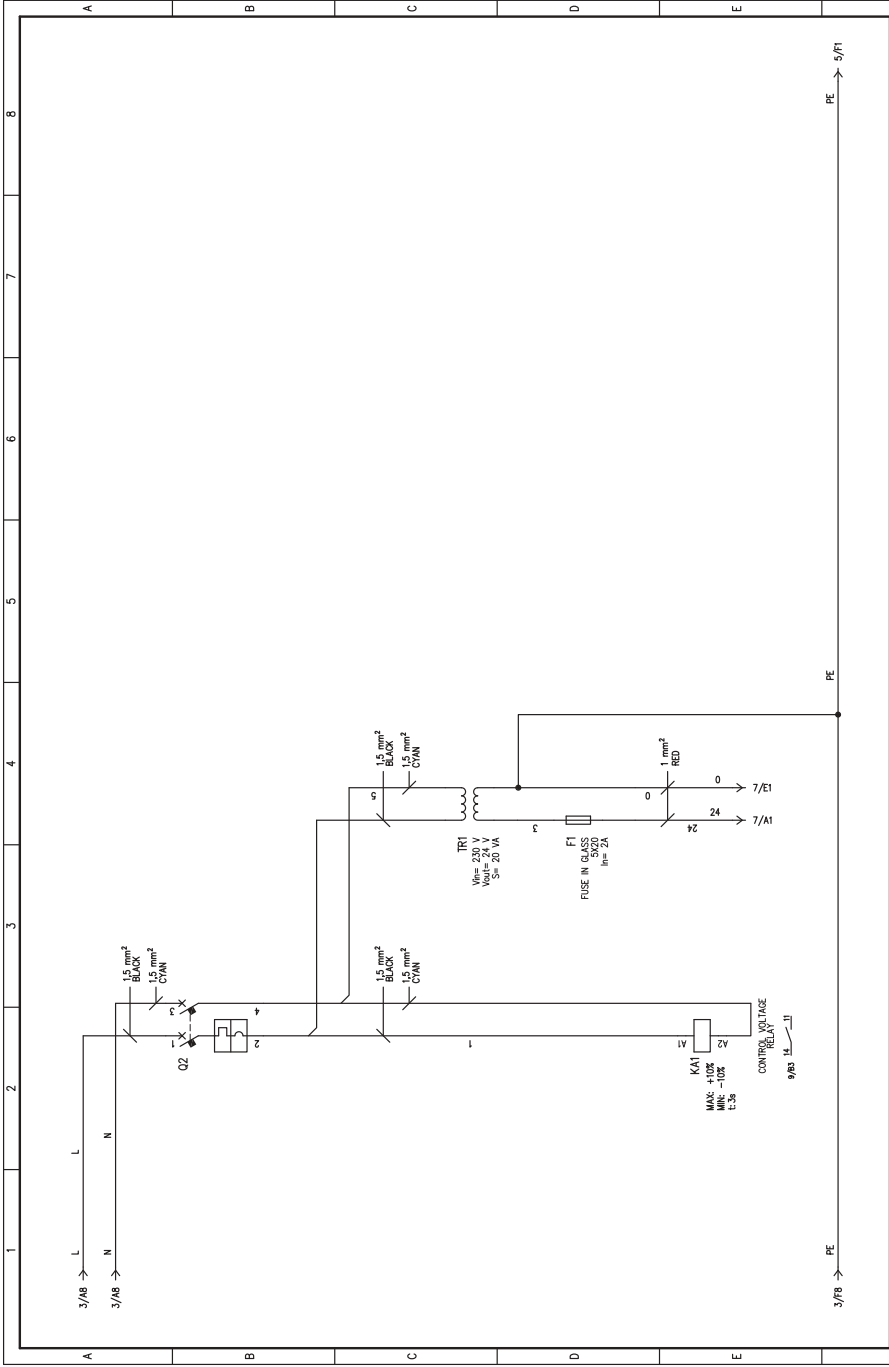

REVISION		DATE	10/07/2017
BY	DRAW	DP1	
DATE	CHECK	INC1	
21/12/2017	APP	IMM	
TOTAL SHEET		19	F
CONTINUE		5	
MINIMATE		4	
HFE20R3431			
SHEET		4	

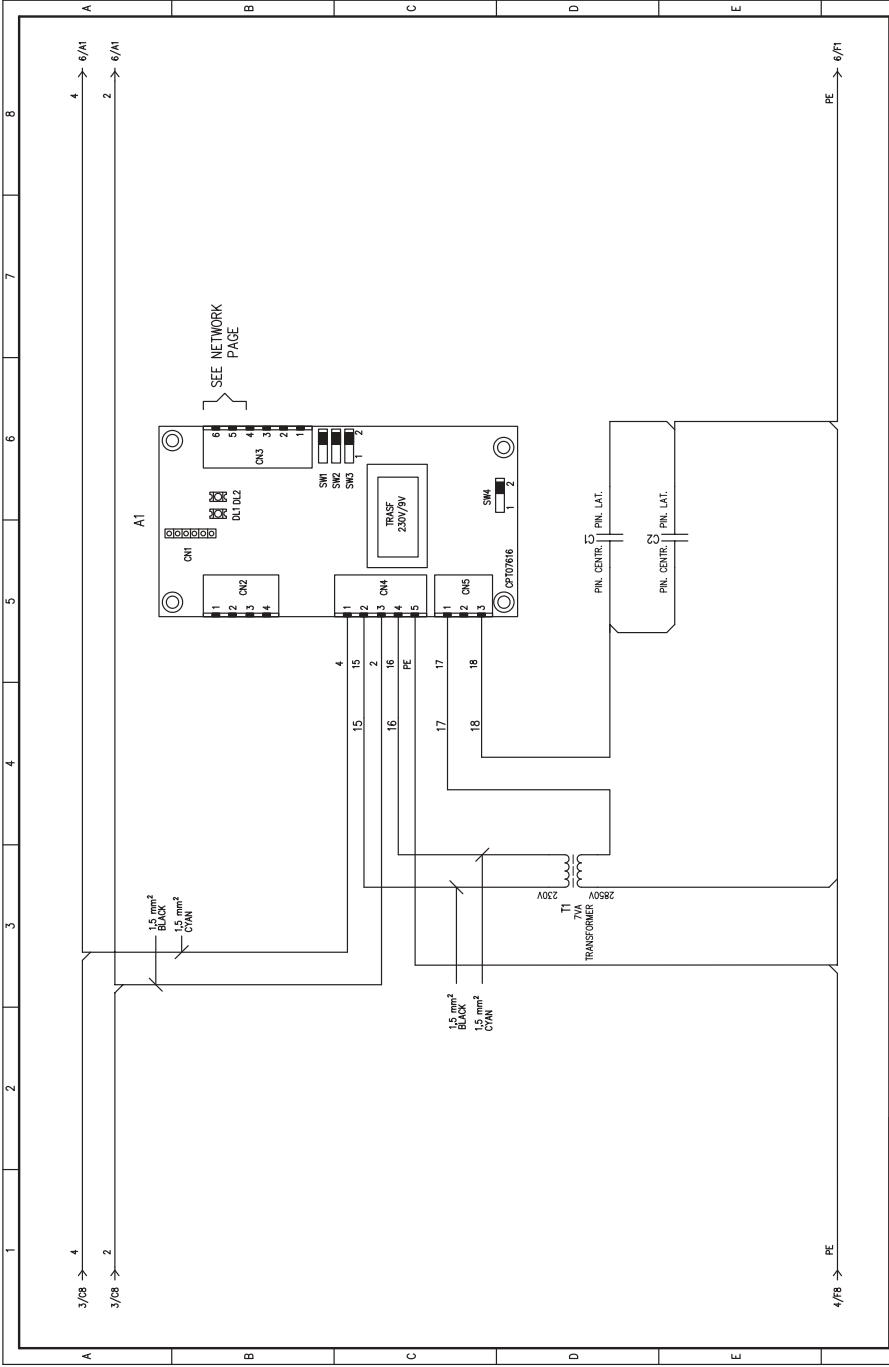

REVISION		DATE	07/03/2017
LAST	BY	DRAWN	DF
C	AD1	CHECKED	INC1
		APPR.	IMM
MINIMATE		4	
HF620R34.31		7	
TOTAL SHEET		18	
CONTINUE		8	
SHEET		5	



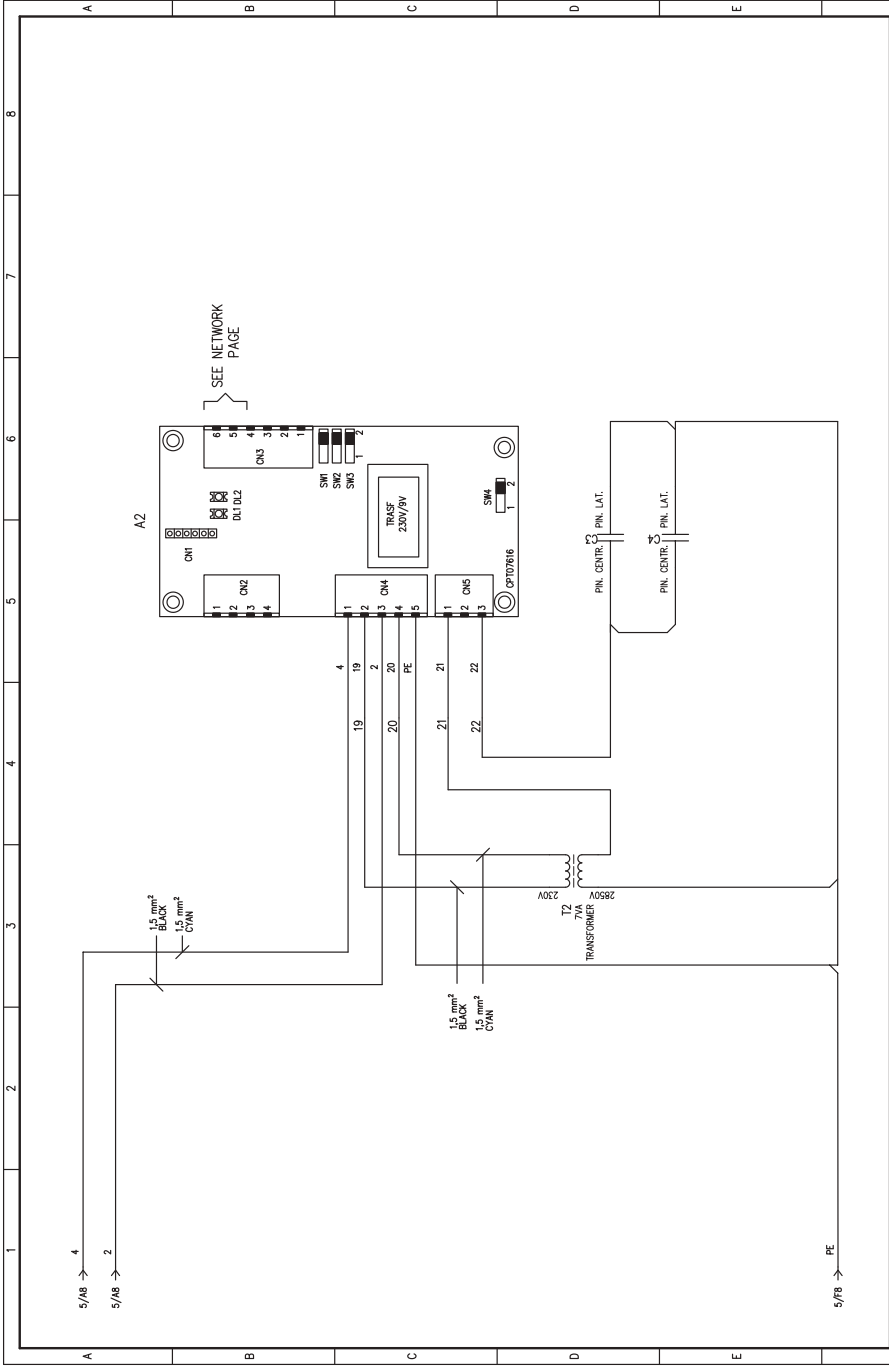

REVISION		DATE	107/03/2017	TOTAL SHEET		19
LAST	BY	DATE	DRAW: DP1	CONTINUE	7	
C	AD1	21/12/2017	CHECKING: I	SHEET	6	
			APPR: IAN	HF62OR3431		
			MINIMATE	7		
			4	8		

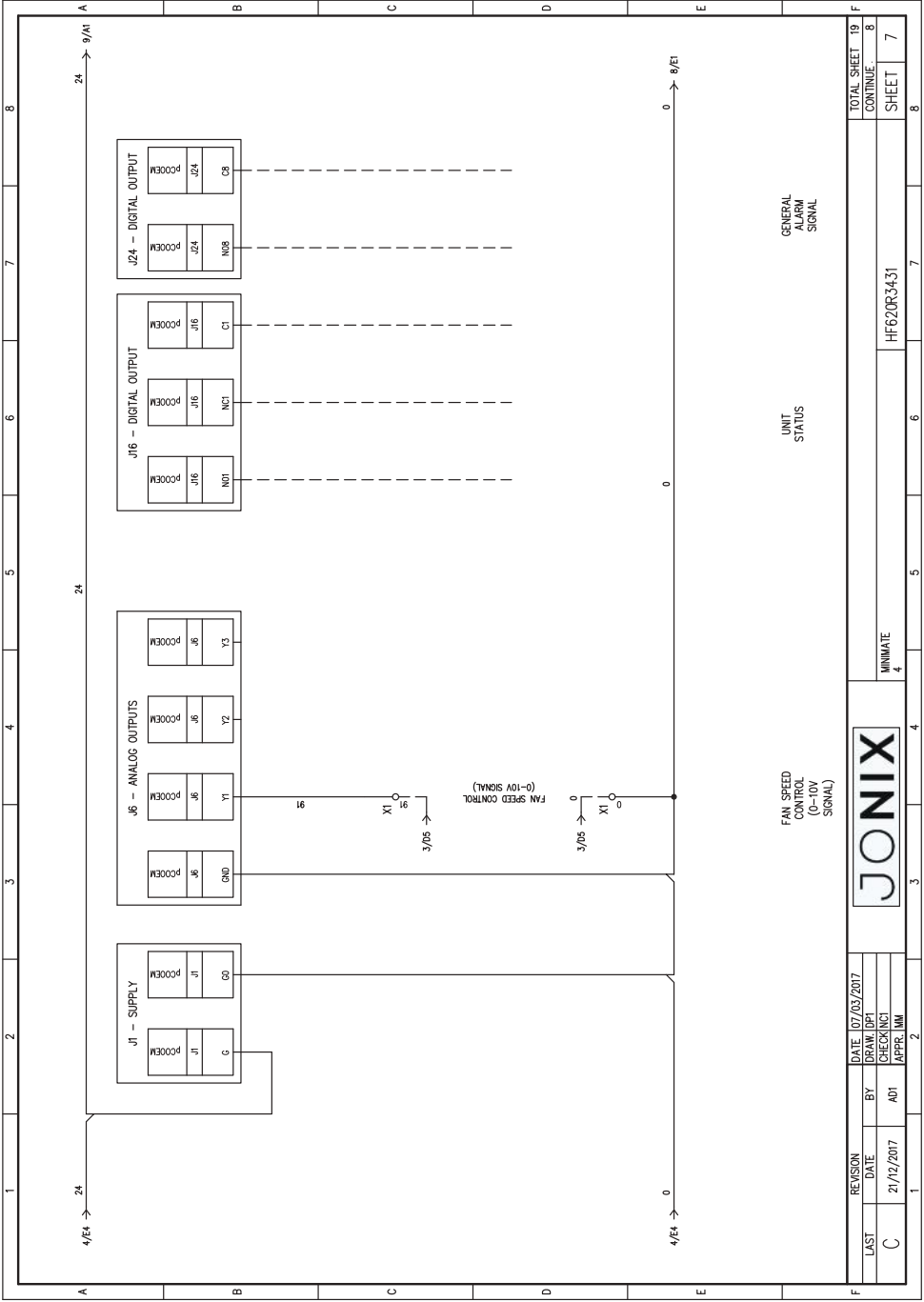

FAN SPEED CONTROL  
(0-10V SIGNAL)

UNIT STATUS  
GENERAL ALARM SIGNAL



REVISION	DATE	BY	DATE
C	21/12/2017	AD1	07/03/2017
		CHEK/NC1	DRW/DF1
		CHEK/NC1	CHK/DF1
		APPR./IM1	APP/DF1

MINIMATE  
4

HF620R34-31

TOTAL SHEET	18
CONTINUE	8
SHEET	7

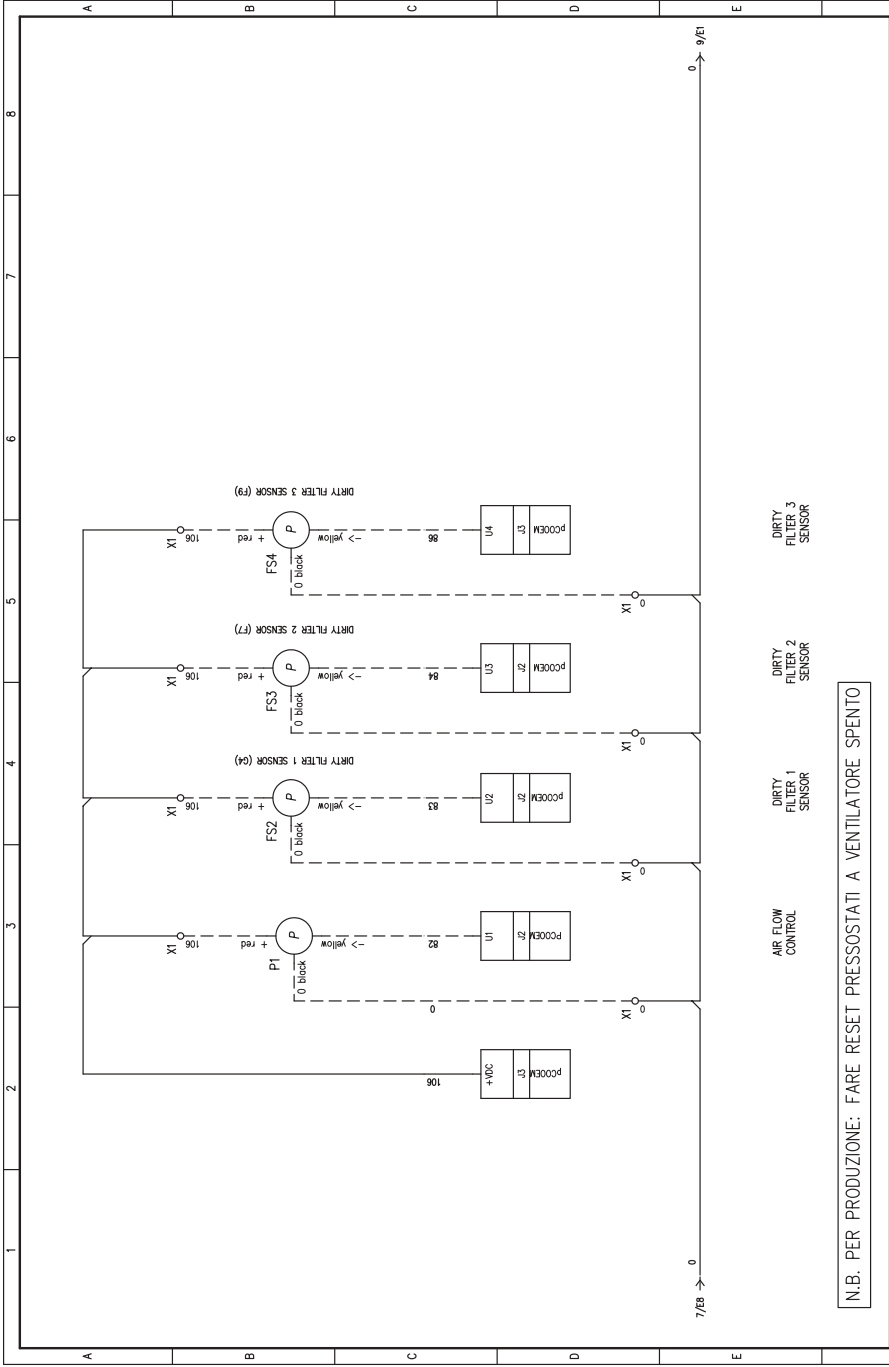

N.B. PER PRODUZIONE: FARE RESET PRESSOSTATI A VENTILATORE SPENTO



REVISION	DATE	107/03/2017
LAST	BY	DRAW: DFI
C	DATE	21/12/2017
	CHECKING	
	APPR.	MM

MINIMATE  
4

HF62OR3431

TOTAL SHEET	19
CONTINUE	9
SHEET	8

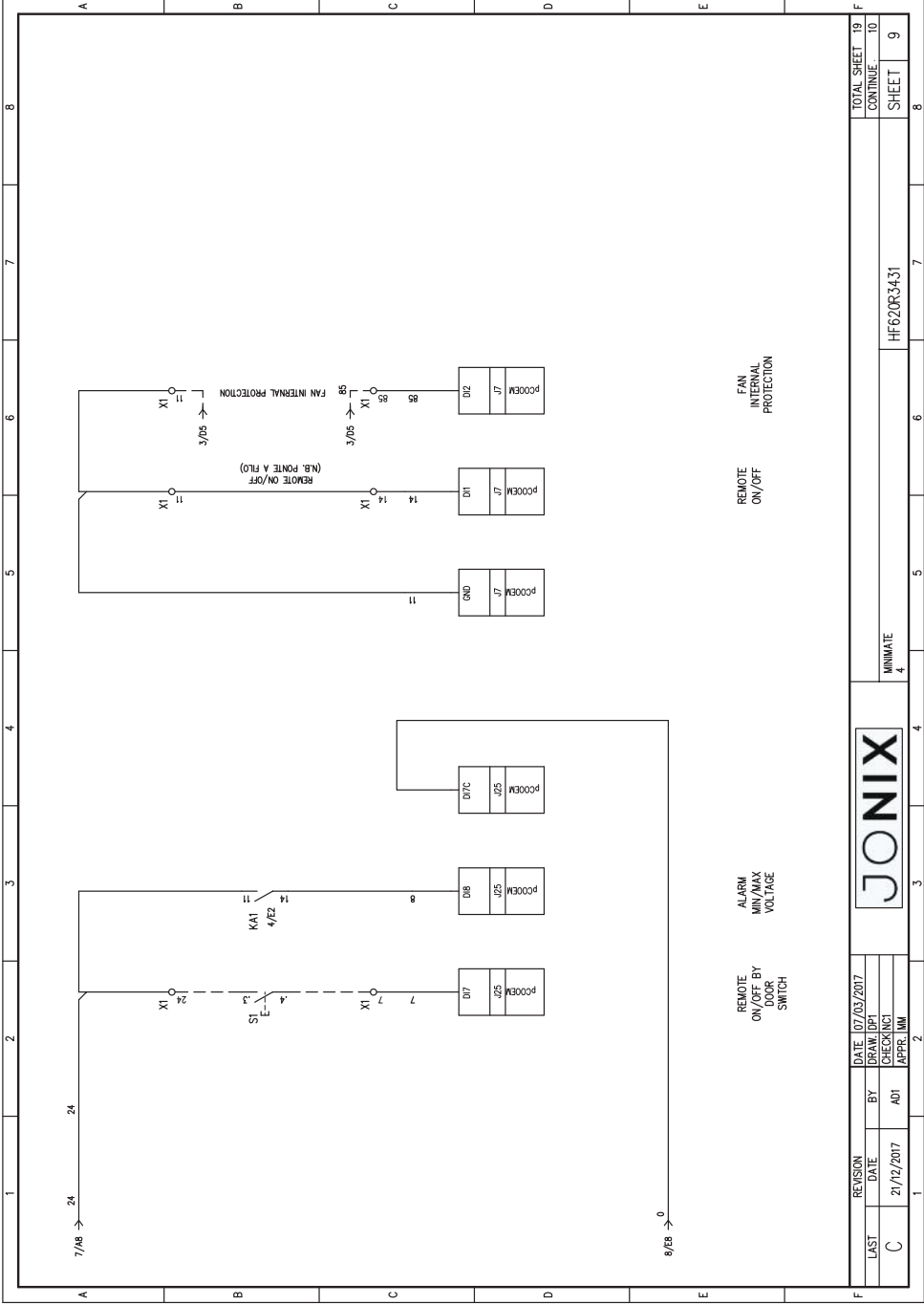

REVISION	DATE	07/03/2017
LAST	DATE	21/12/2017
BY	BY	AD1
CHECKING	CHECKING	
APPR. I.M.I.	APPR. I.M.I.	

MINIMATE  
4

HFC20R34.31

TOTAL SHEET	18
CONTINUE	10
SHEET	9

NETWORK CONNECTION

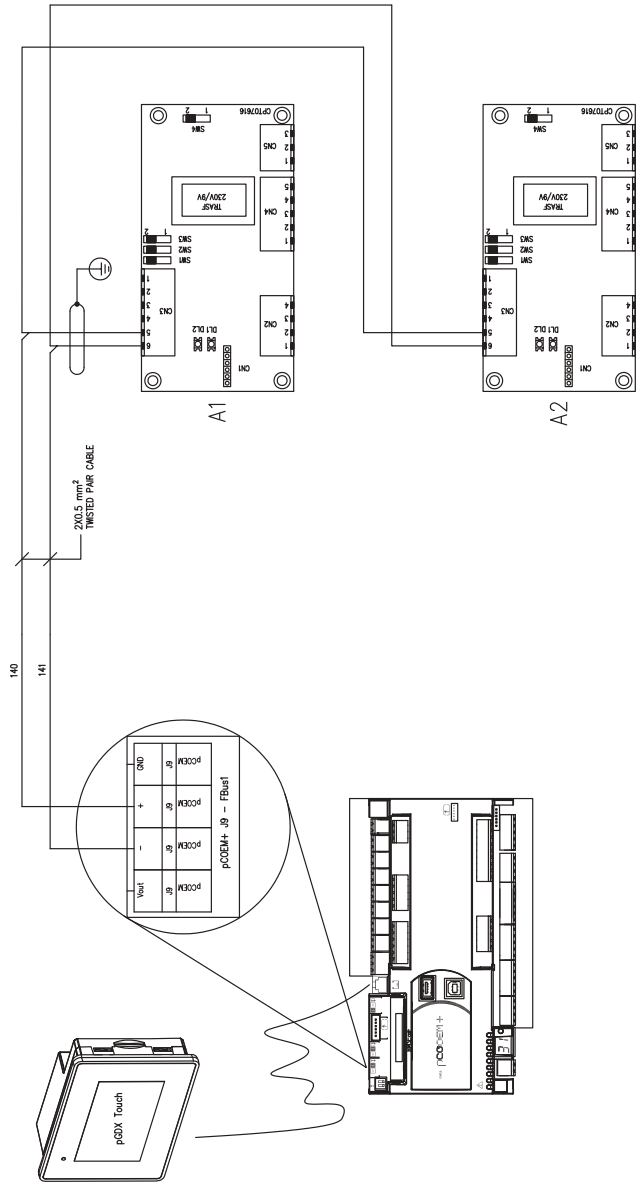

REVISION	DATE	107/03/2017
BY	DRAW	DP1
DATE	CHECK	INC1
21/12/2017	APP	IMM



MINIMATE  
4

HFG2R3431

TOTAL SHEET	19
CONTINUE	11
SHEET	10

TERMINAL STRIP

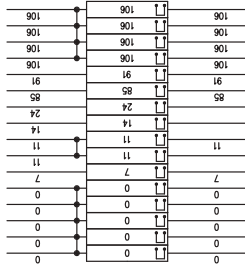

REVISION		DATE	07/03/2017	DATE		07/03/2017	TOTAL SHEET	19
LAST	DATE	BY	AD1	DRAWN	DATE	07/03/2017	CONTINUE	12
C	21/12/2017	AD1	AD1	CHECKING	DATE		SHEET	11
				APPR.	DATE			
				MINIMATE		4	HF620R3431	
				4			8	



# GROUND PLATE LAYOUT

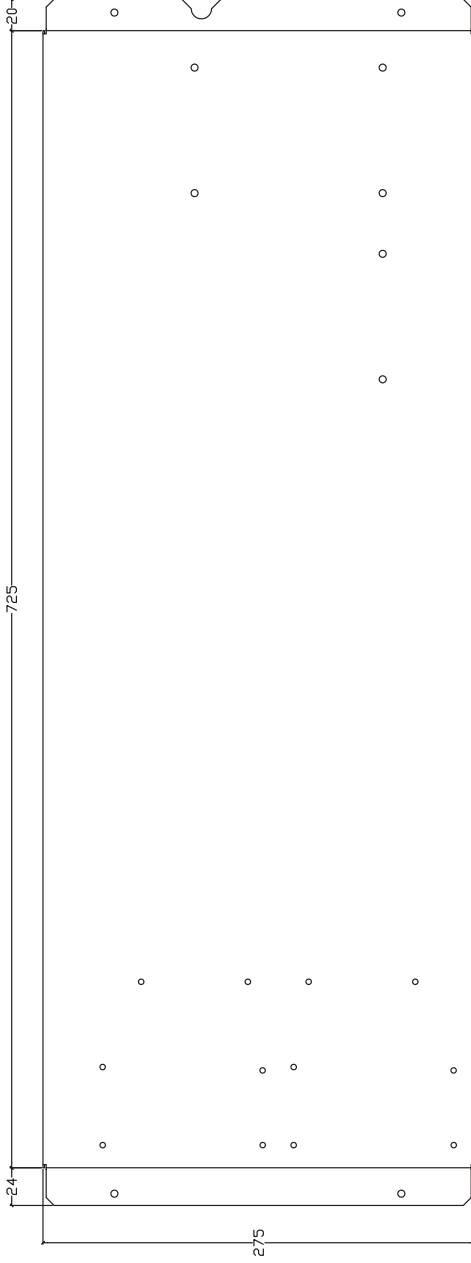

REVISION	DATE	BY	DATE	DATE	DATE
LAST					
C	21/12/2017	AD1			



MINIMATE  
4

HF62OR3431

TOTAL SHEET	19
CONTINUE	14
SHEET	13



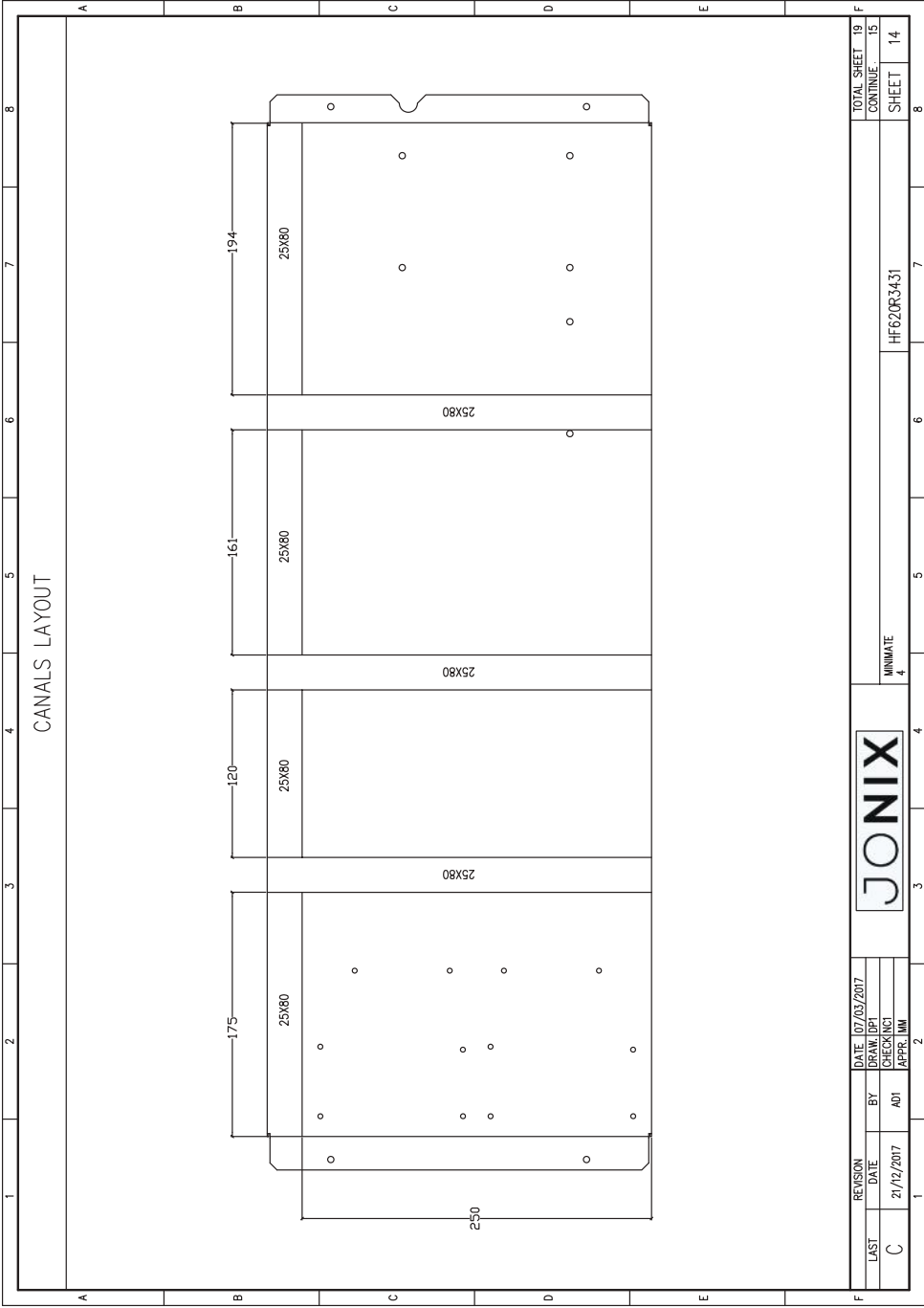

REVISION	DATE	107/03/2017
LAST	BY	DRAW: DFI
C	DATE	21/12/2017
	CHECK	INC1
	APP	IMM

MINIMATE  
4

HFG20R3431

TOTAL SHEET	19
CONTINUE	15
SHEET	14

DIN GUIDE LAYOUT (ALL THE GUIDES MUST BE HIGH 10mm)

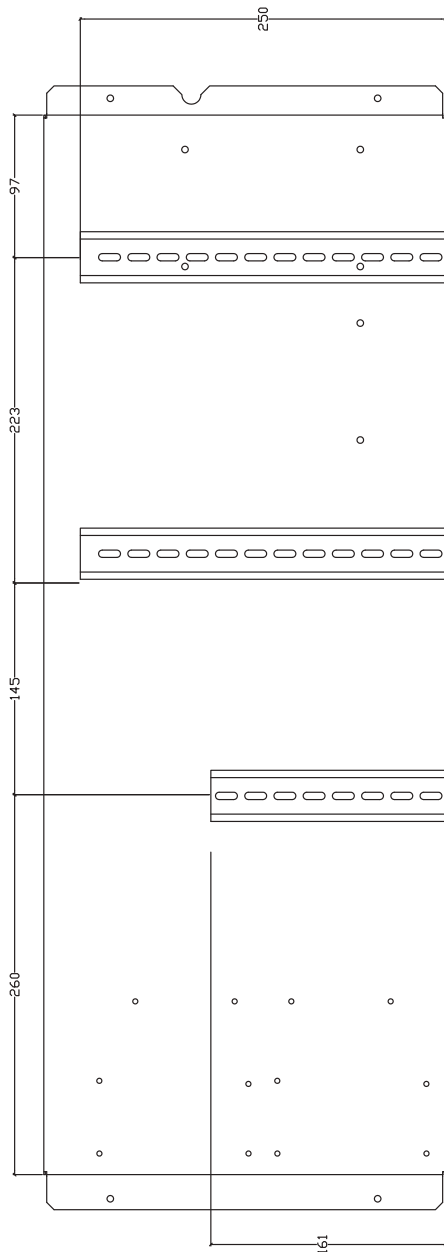

REVISION	DATE	DATE	DATE	DATE	DATE
LAST	DATE	BY	CHECK	CHECK	CHECK
C	21/12/2017	AJ1			
			APPR.	IMM	
				MINIMATE	4
				HFG2QR3431	7
TOTAL SHEET 18				CONTINUE 16	SHEET 15
				8	8

COMPONENTS LAYOUT

C2  
C1

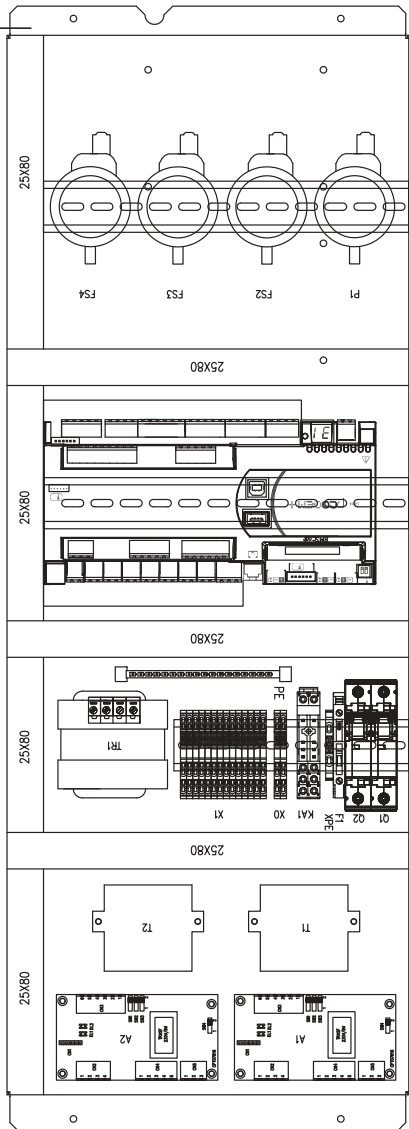

FERMARE QUESTI COMPONENTI CON DEI FERMA MORSETTI



REVISION	DATE	107/03/2017
BY	DRAW	DP1
DATE	CHECK	INC1
21/12/2017	APP	IMM
AD1		

TOTAL SHEET	19
CONTINUE	17
SHEET	16

HFG2OR3431

MINIMATE  
4

# ELECTRICAL UNIT LAYOUT

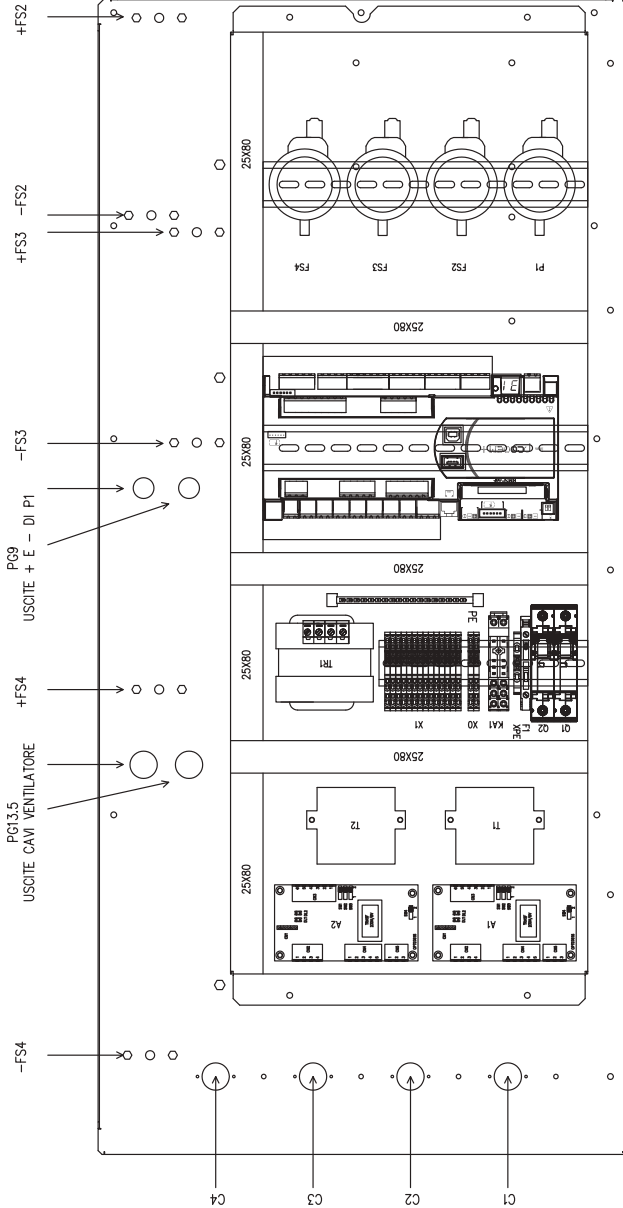

REVISION	DATE	DATE	DATE
LAST	BY	CHECKING	DATE
C	AD1	APP. ILM	21/12/2017



MINIMATE  
4

HFC2QR34.31

TOTAL SHEET	18
CONTINUE	18
SHEET	17

1 2 3 4 5 6 7 8

### REVISIONS LIST

A	REVISION	DATE	BY	MODIFICATIONS	A
	/	07/03/2017	FIRST EMISSION		DP1
A		15/06/2017	GENERAL REVISION		FB1
B		13/11/2017	GROUND PLATE REVISION – ADDED S1		AD1
C		21/12/2017	GENERAL REVISION		AD1

B					B
C					C
D					D
E					E
F	LAST	C	REVISION	DATE 07/03/2017 BY DRAW DP1 CHECK INCI APPR. IAW	TOTAL SHEET CONTINUE 19 SHEET 18



MINIMATE  
4

HFG20R3431

STANDARD BILL OF MATERIALS – HF69003709							
SYMBOL	FUNCTION	BRAND	CODE	DESCRIPTION	QUANTITY	M.U.	
01	FAN-HIONIZERS PROTECTION	SIEMENS	5S16010-7	INT. AUT. IP+N C 10A 6KA	1	PCE	
02	TRANSFORMER PROTECTION	SIEMENS	5S16006-7	INT. AUT. IP+N C 6A 6KA	1	PCE	
F1	FUSE BOX	PHOENIX	3004100	FUSE BOX	1	PCE	
F1	AUXILIARY CIRCUIT PROTECTION	ITALWEBER	104306	FUSE 5X20 Im=6.3A	1	PCE	
TR1	TRANSFORMER	BOTTER	-	TRANSFORMER Vm=230V / Vout=24V S=50VA	1	PCE	
X1 - X0	TERMINAL STRIP	PHOENIX	30312128	CLAMP ST 1.5 TWIN	14	PCE	
C0	ELECTRIC SOCKET WITH LIGHTING SWITCH	OMEGA FUSIBLI	BZ03302	ELECTRIC SOCKET 10A WITH RED SWITCH (A CORREDO)	1	PCE	
C0	PLUG	OMEGA FUSIBLI	PX5670000	FEMALE PLUG CONNECTOR (A CORREDO)	1	PCE	
S1	ELECTRICAL SECURITY SWITCH	EZM	021248	FINE CORSA NO EZM (A CORREDO)	1	PCE	
XPE	TERMINAL STRIP	PHOENIX	3044092	CLAMP UT 2.5-PE	1	PCE	
	GROUND PLATE	HREF	HF0300678	GROUND PLATE	1	PCE	
	GROUND BAR	-	-	GROUND BAR	1	PCE	
TOTAL SHEET 19							
CONTINUE							
MINIMATE							
HF620R3431							
SHEET 19							



REVISION	DATE	BY
1	07/03/2017	AD1
2		
3		
4		
5		
6		
7		
8		

DATE	07/03/2017
DRAWN BY	
CHECKING	
APPR. I.M.M.	



# JONIX

pure living

JONIX srl  
support@jonixair.com  
www.jonixair.com



Registered office  
viale Spagna 31/33  
35020 Tribano (PD) - Italy  
tel +39 049 9588511  
fax +39 049 9588522

Scientific headquarters  
via Tegulaia 10/b  
56121 Pisa - Italy  
tel +39 050 985165

Operational headquarters  
via Romagnoli 12/a  
40010 Bentivoglio (BO) - Italy